

ProPEX brass ball valves

Project information

Job name:	Location:
Engineer:	Date submitted:
Contractor:	Submitted by:
Manufacturer's representative:	Approved by:

Technical data

Cv	132.2
Material	Brass
Subcomponent Material	Seal:
	PTFE
End type 1	ProPEX 2"
End type 2	ProPEX 2"
Cold working pressure	200.2 psi
Temp/pressure ratings	73 °F (23 °C) at 160 psi (11 bar)
	180 °F (82 °C) at 100 psi (6.9 bar)
	200 °F (93 °C) at 80 psi (5.5 bar)
Prop 65 label required?	Yes

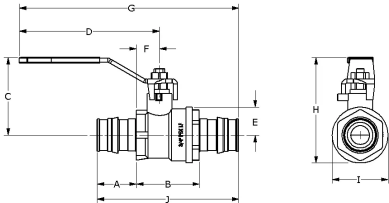

Product information and application use

Uponor ProPEX® Brass Ball Valve is a cost-effective alternative for radiant heating/cooling and hydronic piping applications.¹ Both ends are manufactured with the ProPEX fitting for connections to Uponor PEX pipe. The full-port valves are compatible with propylene glycol mixtures up to 50%. Stem extensions can be installed to accommodate up to 2" of pipe insulation. Note: ProPEX Brass Ball Valves are not approved for potable-water applications.

Part name	Part no.	Codes	Standards	Listings
ProPEX brass ball valves	A3202020	IMC UMC	ASTM F1960 CSA B137.5 NSF/ANSI 14 ASTM F877 NSF/ANSI 359	cNSFus-rfh

Installation

Install valve according to local building code. Do not dismantle. Refer to the Uponor Hydronic Piping Design Assistance Manual (HPDAM) or the Uponor Radiant Floor Heating Installation Handbook for additional information.

Related applications

- Radiant Heating and Cooling Systems
- Permafrost Protection Systems
- Turf Conditioning Systems
- Hydronic Piping Systems

Footnotes

-

Contact information

Uponor Inc. 5925 148th Street West Apple Valley, MN 55124 T 800.321.4739 F 952.891.2008	Uponor Ltd. 6510 Kennedy Road Mississauga, ON L5T 2X4 T 888.594.7726 F 800.638.9517
---	---