

ProPEX lead-free (LF) copper stub ells

Project information

Job name:	Location:
Engineer:	Date submitted:
Contractor:	Submitted by:
Manufacturer's representative:	Approved by:

Technical data

Material	Copper
Subcomponent Material	LF Brass
	Copper
Temp/pressure ratings	73 °F (23 °C) at 160 psi (11 bar)
	180 °F (82 °C) at 100 psi (6.9 bar)
	200 °F (93 °C) at 80 psi (5.5 bar)
Prop 65 label required?	Yes

Product information and application use

Uponor ProPEX® lead-free (LF) copper stub ells provide a 90- degree transition from Uponor AquaPEX® tubing to copper.1 Copper stub ells are comprised of ½", ¾" or 1" type L copper pipe with an Uponor ProPEX fitting on one end and the other end spun closed.

Note: Temperature and pressure ratings stated are hydrostatic ratings. For domestic hot-water (DHW) and DHW recirculation installations, operating conditions should not exceed 140°F (60°C) at 80 psi (5.5 bar) in accordance with ASTM F2023. For additional information regarding application-specific temperature and pressure ratings, refer to the Uponor PEX Piping Systems Design and Installation Manual.

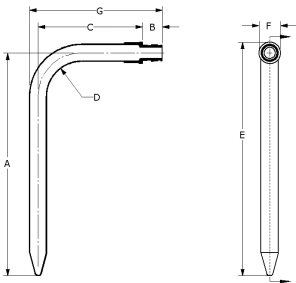

Part name	Part no.	A [mm]	B [mm]	C [mm]	D [mm]	E [mm]	F [mm]	G [mm]	End Type 1	Weight per UOM [kg/UOM]
ProPEX LF Copper Stub Ell, 1/2" PEX LF Brass x 1/2" Copper (3 1/2" x 8")	LF2865050	202.88	18	95.22	78.33	212.66	19.56	121.16	ProPEX 1/2"	0.091
ProPEX LF Copper Stub Ell, 1/2" PEX LF Brass x 1/2" Copper (13" x 8")	LF2855050	202.88	18	312.39	78.33	212.66	19.56	338.33	ProPEX 1/2"	0.227
ProPEX LF Copper Stub Ell, 1/2" PEX LF Brass x 1/2" Copper (8" x 13")	LF2895050	329.82	18	185.29	77.22	339.60	19.56	211.23	ProPEX 1/2"	0.219
ProPEX LF Copper Stub Ell, 3/4" PEX LF Brass x 3/4" Copper (4" x 8")	LF2897575	203.26	24	103.06	100.56	217.23	27.94	138.17	ProPEX 3/4"	0.2268
ProPEX LF Copper Stub Ell, 1" PEX x 1" Copper (13" x 8")	LF2891010	330.20	30	165.28	203.20	347.47	34.54	209.56	ProPEX 1"	0.771

Part name	Part no.	Codes	Standards	Listings
ProPEX lead-free (LF) copper stub ells	All	UPC IBC IRC IPC NPC of Canada UMC NSPC IMC	NSF/ANSI/CAN 372 ASTM F877 ASTM F1960 CSA B137.5 NSF/ANSI/CAN 61 NSF/ANSI 14	IAPMO-ES HUD MR 1269
In addition, the following parts have additional codes, standards, or listings:				
ProPEX LF Copper Stub Ell, 1" PEX x 1" Copper (13" x 8")	LF2891010			

Installation	Related applications
Refer to the Uponor AquaPEX Professional Plumbing Installation Guide for additional information	PEX-a Plumbing Systems

Footnotes	Contact information
-	Uponor Inc. 5925 148th Street West Apple Valley, MN 55124 T 800.321.4739 F 952.891.2008 Uponor Ltd. 6510 Kennedy Road Mississauga, ON L5T 2X4 T 888.594.7726 F 800.638.9517