

ProPEX manifold elbow adapters

Project Information

Job name:	Location:
Engineer:	Date submitted:
Contractor:	Submitted by:
Manufacturer's representative:	Approved by:

Technical data

Material	Brass
End type 2	ISO 228-G 1-1/4"
Temp/pressure ratings	73 °F (23 °C) at 160 psi (11 bar) 180 °F (82 °C) at 100 psi (6.9 bar) 200 °F (93 °C) at 80 psi (5.5 bar)
Prop 65 label required?	Yes

Product Information and application use

Uponor ProPEX® Manifold Elbow Adapter threads into Uponor TruFLOW™ and Engineered Polymer (EP) Heating Manifolds to adapt to ProPEX connections in radiant heating and cooling applications.¹

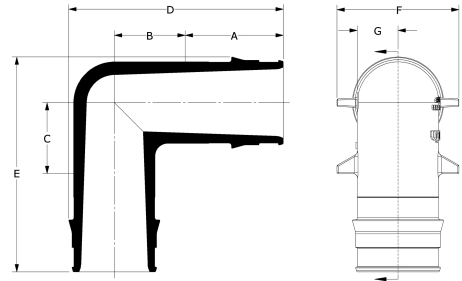

Part name	Part no.	A [inch]	B [inch]	C [inch]	D [inch]	E [inch]	F [inch]	End Type 1	Weight per UOM [lbs/UOM]
ProPEX Manifold Elbow Adapter, R32 x 3/4" ProPEX	Q4153275	0.945	0.9	1.15	2.663	2.33	1.635	ProPEX 3/4"	0.6
ProPEX Manifold Elbow Adapter, R32 x 1" ProPEX	Q4153210	1.181	0.9	1.15	2.898	2.33	1.635	ProPEX 1"	0.62
ProPEX Manifold Elbow Adapter, R32 x 1 1/4" ProPEX	Q4153213	1.445	0.85	1.3	3.113	2.775	1.635	ProPEX 1-1/4"	0.89
ProPEX Manifold Elbow Adapter, R32 x 1 1/2" ProPEX	Q4153215	1.704	0.85	1.3	3.372	2.775	1.635	ProPEX 1-1/2"	0.91

Part name	Part no.	Codes	Standards	Listings
ProPEX manifold elbow adapters	All	IMC IRC NBC of Canada UMC	ASTM F1960 R32: ISO 228-G 1 1/4" ASTM F877	cNSFus-rfh

Installation

R32 threads into the Uponor TruFLOW and EP Heating Manifolds. ProPEX end enables direct, 90-degree contact to Uponor PEX-a tubing. For additional information, refer to the Uponor Radiant Floor Heating Installation Handbook.

Related applications

Radiant Heating and Cooling Systems

Footnotes

Contact information

Uponor Inc.
5925 148th Street West
Apple Valley, MN 55124
T 800.321.4739
F 952.891.2008

Uponor Ltd.
6510 Kennedy Road
Mississauga, ON L5T 2X4
T 888.594.7726
F 800.638.9517