

# ProPEX manifold elbow adapters

## Project Information

Job name:	Location:
Engineer:	Date submitted:
Contractor:	Submitted by:
Manufacturer's representative:	Approved by:

## Technical data

Material	Brass
End type 2	ISO 228-G 1-1/4"
Temp/pressure ratings	73 °F (23 °C) at 160 psi (11 bar) 180 °F (82 °C) at 100 psi (6.9 bar) 200 °F (93 °C) at 80 psi (5.5 bar)
Prop 65 label required?	Yes

## Product Information and application use

Uponor ProPEX® Manifold Elbow Adapter threads into Uponor TruFLOW™ and Engineered Polymer (EP) Heating Manifolds to adapt to ProPEX connections in radiant heating and cooling applications.<sup>1</sup>

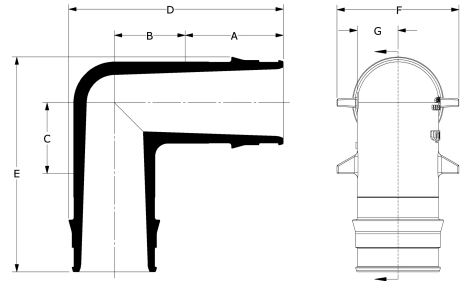

Part name	Part no.	A [inch]	B [inch]	C [inch]	D [inch]	E [inch]	F [inch]	End Type 1	Weight per UOM [lbs/UOM]
ProPEX Manifold Elbow Adapter, R32 x 3/4" ProPEX	Q4153275	0.945	0.9	1.15	2.663	2.33	1.635	ProPEX 3/4"	0.6
ProPEX Manifold Elbow Adapter, R32 x 1" ProPEX	Q4153210	1.181	0.9	1.15	2.898	2.33	1.635	ProPEX 1"	0.62
ProPEX Manifold Elbow Adapter, R32 x 1 1/4" ProPEX	Q4153213	1.445	0.85	1.3	3.113	2.775	1.635	ProPEX 1-1/4"	0.89
ProPEX Manifold Elbow Adapter, R32 x 1 1/2" ProPEX	Q4153215	1.704	0.85	1.3	3.372	2.775	1.635	ProPEX 1-1/2"	0.91

Part name	Part no.	Codes	Standards	Listings
ProPEX manifold elbow adapters	All	IMC IRC NBC of Canada UMC	ASTM F1960 R32: ISO 228-G 1 1/4" ASTM F877	cNSFus-rfh

## Installation

R32 threads into the Uponor TruFLOW and EP Heating Manifolds. ProPEX end enables direct, 90-degree contact to Uponor PEX-a tubing. For additional information, refer to the Uponor Radiant Floor Heating Installation Handbook.

## Related applications

Radiant Heating and Cooling Systems

## Footnotes

## Contact information

Uponor Inc.  
5925 148th Street West  
Apple Valley, MN 55124  
T 800.321.4739  
F 952.891.2008

Uponor Ltd.  
6510 Kennedy Road  
Mississauga, ON L5T 2X4  
T 888.594.7726  
F 800.638.9517