

ProPEX EP opposing-port tees

Project information

Job name:	Location:
Engineer:	Date submitted:
Contractor:	Submitted by:
Manufacturer's representative:	Approved by:

Technical data

Material	Engineered Polymer
End type 3	ProPEX 3/4"
End type 4	ProPEX 3/4"
Temp/pressure ratings	73 °F (23 °C) at 160 psi (11 bar) 180 °F (82 °C) at 100 psi (6.9 bar) 200 °F (93 °C) at 80 psi (5.5 bar)

Product information and application use

ProPEX® engineered polymer (EP) opposing-port tees feature 1" through 2" ProPEX flow-through connections with opposing 3/4" ProPEX branch outlets. 1

Note: Temperature and pressure ratings stated are hydrostatic ratings. For domestic hot-water (DHW) and DHW recirculation installations, operating conditions should not exceed 140°F (60°C) at 80 psi (5.5 bar) in accordance with ASTM F2023. For additional information regarding application-specific temperature and pressure ratings, refer to the Uponor PEX Piping Systems Design and Installation Manual.

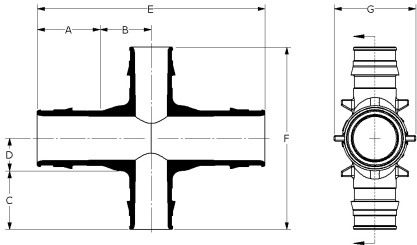

Part name	Part no.	A [inch]	B [inch]	C [inch]	D [inch]	E [inch]	F [inch]	G [inch]	Cv Through	Equivalent length branch [ft]	Equivalent length through [ft]
ProPEX EP Opposing-port Tee 1" x 1" x 3/4" x 3/4	Q4801075	1.191	0.875	0.955	0.7	4.132	3.31	1.48	34.1	5.53	0.86
ProPEX EP Opposing-port Tee 1 1/4" x 1 1/4" x 3/4" x 3/4	Q4801375	1.455	0.9	0.955	0.75	4.71	3.41	1.82	57.1	5.29	0.83
ProPEX EP Opposing-port Tee 1 1/2" x 1 1/2" x 3/4" x 3/4	Q4801575	1.714	1	0.955	0.9	5.428	3.71	2.07	69.3	5.34	1.39
ProPEX EP Opposing-port Tee 2" x 2" x 3/4" x 3/4	Q4802075	2.157	1.05	0.955	1.04	6.414	3.99	2.82	130	5.2	1.44

Part name	Part no.	Cv Branch	End Type 1	End Type 2	Weight per UOM [lbs/UOM]
ProPEX EP Opposing-port Tee 1" x 1" x 3/4" x 3/4	Q4801075	8.9	ProPEX 1"	ProPEX 1"	0.09
ProPEX EP Opposing-port Tee 1 1/4" x 1 1/4" x 3/4" x 3/4	Q4801375	9.1	ProPEX 1-1/4"	ProPEX 1-1/4"	0.12
ProPEX EP Opposing-port Tee 1 1/2" x 1 1/2" x 3/4" x 3/4	Q4801575	9	ProPEX 1-1/2"	ProPEX 1-1/2"	0.17
ProPEX EP Opposing-port Tee 2" x 2" x 3/4" x 3/4	Q4802075	9.1	ProPEX 2"	ProPEX 2"	1.32

Part name	Part no.	Codes	Standards	Listings
ProPEX EP opposing-port tees	All	IMC UPC IBC IRC IPC NPC of Canada UMC NSPC	ASTM F1960 ASTM E119 UL 263 ASTM E84 ASTM E814 ULC S115 ASTM F877 CSA B137.5 ULC S102.2 NSF-61 ULC S101 NSF-14	IAPMO-ES ICC-ES-PMG cNSFus-pw UL U.P.Code cQAlus P321 HUD MR 1269

Installation	Related applications
Use the appropriate ProPEX ring for PEX piping. Refer to the Uponor Piping Pocket Guide or the Uponor Hydronic Piping Design Assistance Manual (HPDAM) for additional information.	Hydronic Radiant Heating and Cooling Systems

Footnotes	Contact information
-	Uponor Inc. 5925 148th Street West Apple Valley, MN 55124 T 800.321.4739 F 952.891.2008 Uponor Ltd. 6510 Kennedy Road Mississauga, ON L5T 2X4 T 888.594.7726 F 800.638.9517