

Copper valved manifold accessories - ProPEX ball and balancing valves



Project information

Job name:	Location:
Engineer:	Date submitted:
Contractor:	Submitted by:
Manufacturer's representative:	Approved by:

Technical data

Material	Brass
Subcomponent Material	CA 360 Brass
End type 2	Sweat 3/4"
Cold working pressure	249.5 psi
Temp/pressure ratings	73 °F (23 °C) at 160 psi (11 bar) 180 °F (82 °C) at 100 psi (6.9 bar) 200 °F (93 °C) at 80 psi (5.5 bar)
Prop 65 label required?	Yes

Product information and application use

The Uponor ProPEX® Ball and Balance Valve products feature in-line isolation valves.1

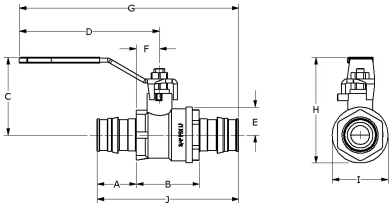

Part name	Part no.	Cv	End Type 1
ProPEX Ball and Balancing Valve, 5/8" PEX x 3/4" Copper Adapter	Q5906375	6.6	ProPEX 5/8"
ProPEX Ball and Balancing Valve, 3/4" PEX x 3/4" Copper Adapter	Q5907575	6.7	ProPEX 3/4"

Part name	Part no.	Codes	Standards	Listings
Copper valved manifold accessories - ProPEX ball and balancing valves	All	-	ASTM F1960 ASTM F877	-

Installation

Install valve according to local building code. Do not dismantle. If soldering, aim flame away from fitting. Remove safety cap. Using Allen key or hex wrench, fully close memory spindle by performing a complete clockwise turn and open it the required number of turns from the closed position. For balancing of manifolds, open the memory spindle fully for the longest loop and balance the other loops by setting their memory spindles according to their loop lengths relative to the longest loop. Refer to the Radiant Floor Installation Handbook for additional information.

Related applications

- PEX-a Plumbing Systems
- Radiant Heating and Cooling Systems
- Permafrost Protection Systems
- Turf Conditioning Systems

Notes

Cv (Q5906375):
6.60
Cv (Q5907575): 6.70

Footnotes

Contact information

-	Uponor Inc. 5925 148th Street West Apple Valley, MN 55124 T 800.321.4739 F 952.891.2008	Uponor Ltd. 6510 Kennedy Road Mississauga, ON L5T 2X4 T 888.594.7726 F 800.638.9517
---	---	---