

# ProPEX lead-free (LF) brass residential ball valves

## Project Information

Job name:	Location:
Engineer:	Date submitted:
Contractor:	Submitted by:
Manufacturer's representative:	Approved by:

## Technical data

Material	LF Brass
Manifold size	inch
Temp/pressure ratings	200 °F (93 °C) at 200 psi (13.8 bar)
Prop 65 label required?	Yes

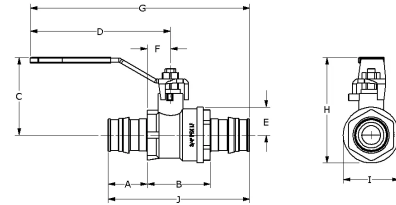

Part name	Part no.	A [inch]	B [inch]	C [inch]	D [inch]	E [inch]	F [inch]	G [inch]	H [inch]	I [inch]	J [inch]
ProPEX LF Brass Stop and Drain Ball Valve (full port), 1" PEX x 1" PEX	LFD4811010	1.181	1.862	1.978	4.227	0.746	0.909	6.361	2.724	2.022	4.224
ProPEX LF Brass Stop and Drain Ball Valve (full port), 1/2" PEX x 1/2" PEX	LFD4815050	0.709	1.449	2.867	3.681	1.624	0.725	5.114	2.071	1.437	2.867
ProPEX LF Brass Stop and Drain Ball Valve (full port), 3/4" PEX x 3/4" PEX	LFD4817575	0.945	1.657	1.841	4.241	0.602	0.803	6.04	2.443	1.726	3.548
ProPEX LF Brass Ball Valve (full port), 1" PEX x 1" PEX	LFR4811010	1.181	1.618	2.208	4.503	0.746	0.685	6.617	2.954	1.492	3.98
ProPEX LF Brass Ball Valve (full port), 1/2" PEX x 1/2" PEX	LFR4815050	0.709	1.228	1.647	3.361	0.447	0.465	4.834	2.094	0.939	2.646
ProPEX LF Brass Ball Valve (full port), 3/4" PEX x 3/4" PEX	LFR4817575	0.945	1.357	1.796	3.361	0.634	0.522	5.142	2.43	1.268	3.247

Part name	Part no.	Cv	Cv Through	Weight per UOM [lbs/UOM]	End Type 1	End Type 2
ProPEX LF Brass Stop and Drain Ball Valve (full port), 1" PEX x 1" PEX	LFD4811010	31.7	-	0.9	ProPEX 1"	ProPEX 1"
ProPEX LF Brass Stop and Drain Ball Valve (full port), 1/2" PEX x 1/2" PEX	LFD4815050	6.5	-	0.35	ProPEX 1/2"	ProPEX 1/2"
ProPEX LF Brass Stop and Drain Ball Valve (full port), 3/4" PEX x 3/4" PEX	LFD4817575	16.6	-	0.6	ProPEX 3/4"	ProPEX 3/4"
ProPEX LF Brass Ball Valve (full port), 1" PEX x 1" PEX	LFR4811010	31.4	-	0.88	ProPEX 1"	ProPEX 1"
ProPEX LF Brass Ball Valve (full port), 1/2" PEX x 1/2" PEX	LFR4815050	6.7	-	0.34	ProPEX 1/2"	ProPEX 1/2"
ProPEX LF Brass Ball Valve (full port), 3/4" PEX x 3/4" PEX	LFR4817575	15.8	-	0.5	ProPEX 3/4"	ProPEX 3/4"

## Installation

## Related applications

-

-

## Codes

## Standards

## Listings

UPC|IBC|IRC|IPC|NPC of Canada|UMC|IMC

NSF-372|ASTM F877|NSF-359|ASTM F1960|CSA B137.5|NSF-61|NSF-14

cNSFus-pw-G|U.P.Code

## Footnotes

## Contact information

-

Uponor Inc.  
5925 148th Street West  
Apple Valley, MN 55124  
T 800.321.4739  
F 952.891.2008

Uponor Ltd.  
6510 Kennedy Road  
Mississauga, ON L5T 2X4  
T 888.594.7726  
F 800.638.9517