

# ProPEX lead-free (LF) brass transition ball valve - FNPT

## Project information

Job name:	Location:
Engineer:	Date submitted:
Contractor:	Submitted by:
Manufacturer's representative:	Approved by:

## Technical data

Material	LF Brass
Cold working pressure	250 psi
Temp/pressure ratings	200 °F (93 °C) at 200 psi (13.8 bar)
Prop 65 label required?	Yes

## Product information and application use

These full-port ball valves with stainless-steel stems provide reliable, high-flow performance and allow contractors to speed installations in tight spaces for greater jobsite productivity while offering engineers optimal hybrid design opportunities to meet pressure, temperature, and space requirements.

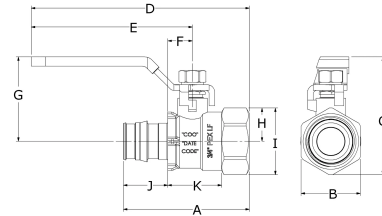

Part name	Part no.	A [inch]	B [inch]	C [inch]	D [inch]	E [inch]	F [inch]	G [inch]	H [inch]	I [inch]	J [inch]
ProPEX LF Brass Transition Ball Valve (full port) SS Ball and Stem 1/2" PEX x 1/2" FNPT	LFT4905050SS	2.37	0.984	2.133	4.622	3.425	0.465	1.583	0.55	1.101	0.709
ProPEX LF Brass Transition Ball Valve (full port) SS Ball and Stem 3/4" PEX x 3/4" FNPT	LFT4907575SS	2.677	1.26	2.499	4.634	3.425	0.524	1.791	0.708	1.416	0.945
ProPEX LF Brass Transition Ball Valve (full port) SS Ball and Stem 1" PEX x 1" FNPT	LFT4901010SS	3.264	1.535	3.072	5.945	4.547	0.685	2.236	0.835	1.67	1.181
ProPEX LF Brass Transition Ball Valve (full port) SS Ball and Stem 1 1/4" PEX x 1 1/4" FNPT	LFT4901313SS	3.807	2	3.396	6.089	4.547	0.821	2.396	1	2	1.445
ProPEX LF Brass Transition Ball Valve (full port) SS Ball and Stem 1 1/2" PEX x 1 1/2" FNPT	LFT4901515SS	4.37	2.25	4.217	7.323	5.638	0.98	3.091	1.124	2.249	1.705
ProPEX LF Brass Transition Ball Valve (full port) SS Ball and Stem 2" PEX x 2" FNPT	LFT4902020SS	5.157	3.031	4.878	7.528	5.638	1.122	3.362	1.516	3.031	2.146
ProPEX LF Brass Transition Ball Valve (full port) SS Ball and Stem 2 1/2" PEX x 2 1/2" FNPT	LFT4902525SS	7.141	3.679	6.53	12.264	9.508	1.594	4.518	1.862	3.722	2.79
ProPEX LF Brass Transition Ball Valve (full port) SS Ball and Stem 3" PEX x 3" FNPT	LFT4903030SS	8.281	4.375	7.199	12.559	9.508	1.89	5.012	2.187	4.375	3.34

Part name	Part no.	K [inch]	Cv	End Type 1	End Type 2	Weight per UOM [lbs/UOM]
ProPEX LF Brass Transition Ball Valve (full port) SS Ball and Stem 1/2" PEX x 1/2" FNPT	LFT4905050SS	1.051	4.7	ProPEX 1/2"	FNPT 1/2"	0.36
ProPEX LF Brass Transition Ball Valve (full port) SS Ball and Stem 3/4" PEX x 3/4" FNPT	LFT4907575SS	1.122	10.9	ProPEX 3/4"	FNPT 3/4"	0.52
ProPEX LF Brass Transition Ball Valve (full port) SS Ball and Stem 1" PEX x 1" FNPT	LFT4901010SS	1.315	17	ProPEX 1"	FNPT 1"	0.86
ProPEX LF Brass Transition Ball Valve (full port) SS Ball and Stem 1 1/4" PEX x 1 1/4" FNPT	LFT4901313SS	1.618	28.1	ProPEX 1-1/4"	FNPT 1-1/4"	1.38
ProPEX LF Brass Transition Ball Valve (full port) SS Ball and Stem 1 1/2" PEX x 1 1/2" FNPT	LFT4901515SS	1.887	41	ProPEX 1-1/2"	FNPT 1-1/2"	2.04
ProPEX LF Brass Transition Ball Valve (full port) SS Ball and Stem 2" PEX x 2" FNPT	LFT4902020SS	2.244	66.7	ProPEX 2"	FNPT 2"	3.43
ProPEX LF Brass Transition Ball Valve (full port) SS Ball and Stem 2 1/2" PEX x 2 1/2" FNPT	LFT4902525SS	3.169	105.7	ProPEX 2-1/2"	FNPT 2-1/2"	8.6
ProPEX LF Brass Transition Ball Valve (full port) SS Ball and Stem 3" PEX x 3" FNPT	LFT4903030SS	3.681	176.2	ProPEX 3"	FNPT 3"	11.36

Part name	Part no.	Codes	Standards	Listings
ProPEX lead-free (LF) brass transition ball valve - FNPT	All	UPC IBC IRC IPC NPC of Canada UMC IMC	ASTM F877 NSF/ANSI/CAN 372 NSF/ANSI 359 ASTM F1960 CSA B137.5 NSF/ANSI/CAN 61 NSF/ANSI 14	cNSFus-pw-G U.P.Code
In addition, the following parts have additional codes, standards, or listings:				
ProPEX LF Brass Transition Ball Valve (full port) SS Ball and Stem 3/4" PEX x 3/4" FNPT	LFT4907575SS			
ProPEX LF Brass Transition Ball Valve (full port) SS Ball and Stem 2" PEX x 2" FNPT	LFT4902020SS			
ProPEX LF Brass Transition Ball Valve (full port) SS Ball and Stem 2 1/2" PEX x 2 1/2" FNPT	LFT4902525SS			
ProPEX LF Brass Transition Ball Valve (full port) SS Ball and Stem 3" PEX x 3" FNPT	LFT4903030SS			
Installation		Related applications		
Use ProPEX LF brass transition ball valves for threaded, press, and flange connections in domestic water and mechanical HVAC piping applications.		-		
Footnotes		Contact information		
-		Uponor Inc. 5925 148th Street West Apple Valley, MN 55124 T 800.321.4739 F 952.891.2008	Uponor Ltd. 6510 Kennedy Road Mississauga, ON L5T 2X4 T 888.594.7726 F 800.638.9517	