

# ProPEX lead-free (LF) brass transition ball valve - Flange

## Project information

|                                |                 |
|--------------------------------|-----------------|
| Job name:                      | Location:       |
| Engineer:                      | Date submitted: |
| Contractor:                    | Submitted by:   |
| Manufacturer's representative: | Approved by:    |

## Technical data

|                         |                                      |
|-------------------------|--------------------------------------|
| Material                | LF Brass                             |
| Cold working pressure   | 250 psi                              |
| Temp/pressure ratings   | 200 °F (93 °C) at 200 psi (13.8 bar) |
| Prop 65 label required? | Yes                                  |

## Product information and application use

These full-port ball valves with stainless-steel stems provide reliable, high-flow performance and allow contractors to speed installations in tight spaces for greater jobsite productivity while offering engineers optimal hybrid design opportunities to meet pressure, temperature, and space requirements.

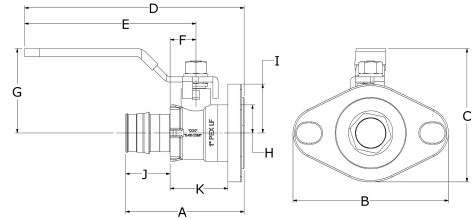

| Part name   | Part no.     | A<br>[inch] | B<br>[inch] | C<br>[inch] | D<br>[inch] | E<br>[inch] | F<br>[inch] | G<br>[inch] | H<br>[inch] | I<br>[inch] | J<br>[inch] |
|---|--------------|-------------|-------------|-------------|-------------|-------------|-------------|-------------|-------------|-------------|-------------|
| ProPEX LF Brass Transition Ball Valve (full port) SS Ball and Stem 3/4" PEX x 3/4" Flange     | LFT4947575SS | 2.598       | 4.125       | 3.086       | 4.555       | 3.425       | 0.524       | 1.791       | 0.62        | 1.295       | 0.945       |
| ProPEX LF Brass Transition Ball Valve (full port) SS Ball and Stem 1" PEX x 1" Flange         | LFT4941010SS | 3.146       | 4.125       | 3.531       | 5.827       | 4.547       | 0.685       | 2.236       | 0.748       | 1.295       | 1.181       |
| ProPEX LF Brass Transition Ball Valve (full port) SS Ball and Stem 1 1/4" PEX x 1 1/4" Flange | LFT4941313SS | 3.748       | 4.125       | 3.691       | 6.03        | 4.547       | 0.821       | 2.396       | 0.915       | 1.295       | 1.445       |

| Part name   | Part no.     | K [inch] | Cv   | End Type 1    | End Type 2    | Weight per UOM<br>[lbs/UOM] |
|---|--------------|----------|------|---------------|---------------|-----------------------------|
| ProPEX LF Brass Transition Ball Valve (full port) SS Ball and Stem 3/4" PEX x 3/4" Flange     | LFT4947575SS | 1.24     | 14   | ProPEX 3/4"   | Flange 3/4"   | 1.02                        |
| ProPEX LF Brass Transition Ball Valve (full port) SS Ball and Stem 1" PEX x 1" Flange         | LFT4941010SS | 1.335    | 24.2 | ProPEX 1"     | Flange 1"     | 1.45                        |
| ProPEX LF Brass Transition Ball Valve (full port) SS Ball and Stem 1 1/4" PEX x 1 1/4" Flange | LFT4941313SS | 1.594    | 40.4 | ProPEX 1-1/4" | Flange 1-1/4" | 1.89                        |

| Part name  | Part no. | Codes                                 | Standards   | Listings             |
|--|----------|---------------------------------------|---|----------------------|
| ProPEX lead-free (LF) brass transition ball valve - Flange | All      | UPC IBC IRC IPC NPC of Canada UMC IMC | ASTM F877 NSF/ANSI/CAN 372 NSF/ANSI 359 ASTM F1960 CSA B137.5 NSF/ANSI/CAN 61 NSF/ANSI 14 | cNSFus-pw-G U.P.Code |

In addition, the following parts have additional codes, standards, or listings:

|   |              |
|---|--------------|
| ProPEX LF Brass Transition Ball Valve (full port) SS Ball and Stem 3/4" PEX x 3/4" Flange     | LFT4947575SS |
| ProPEX LF Brass Transition Ball Valve (full port) SS Ball and Stem 1 1/4" PEX x 1 1/4" Flange | LFT4941313SS |

## Installation

Use ProPEX LF brass transition ball valves for threaded, press, and flange connections in domestic water and mechanical HVAC piping applications.

## Related applications

## Footnotes

-

## Contact information

Uponor Inc.  
5925 148th Street West  
Apple Valley, MN 55124  
T 800.321.4739  
F 952.891.2008

Uponor Ltd.  
6510 Kennedy Road  
Mississauga, ON L5T 2X4  
T 888.594.7726  
F 800.638.9517