

# TruFLOW Jr. assemblies with balancing and isolation valves

## Project Information

Job name :	Location :
Engineer :	Date submitted:
Contractor :	Submitted by:
Manufacturer's representative :	Approved by :

## Technical data

Material	Brass
Manifold size	1 inch
Loop Cv	1.9 Cv
End type 1	ISO 228-G 1-1/4"
End type 2	ISO 228-G 3/4"
Temp/pressure ratings	73 °F (23 °C) at 160 psi (11 bar) 180 °F (82 °C) at 100 psi (6.9 bar) 200 °F (93 °C) at 80 psi (5.5 bar)
Max. fluid flow rate	14 gpm
Prop 65 label required?	Yes

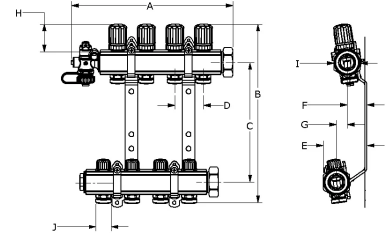

## Product information and application use

The TruFLOW™ Jr. Assembly with Balancing and Isolation Valves comes fully assembled and ready for installation. Use the TruFLOW Balancing Hex Key on the internal balancing valves of the supply manifold to balance the loops across the manifold. The TruFLOW Jr. Manifold with Isolation Valves allows quick isolation of the loop by turning the black cap on the top of the manifold. For multiple zoning on the manifold, remove the black caps and replace with Uponor Thermal Actuators or Motorized Valve Actuators (MVAs). The manifold assembly is shipped with the appropriate number of TruFLOW Manifold Actuator Adapters. The manifold body ends have R32 unions and the loop outlets have R20 male threads.

Part name	Part no.	A [inch]	B [inch]	C [inch]	D [inch]	E [inch]	F [inch]	G [inch]	H [inch]	I [inch]	J [inch]
TruFLOW Jr. Assembly, B&I, 2-loop	A2660201	7.185	12.214	8.248	1.969	2.9	1.285	0.728	1.763	1.811	1.035
TruFLOW Jr. Assembly, B&I, 3-loop	A2660301	9.154	12.214	8.248	1.969	2.9	1.285	0.728	1.763	1.811	1.035
TruFLOW Jr. Assembly, B&I, 4-loop	A2660401	11.122	12.214	8.248	1.969	2.9	1.285	0.728	1.763	1.811	1.035
TruFLOW Jr. Assembly, B&I, 5-loop	A2660501	13.091	12.214	8.248	1.969	2.9	1.285	0.728	1.763	1.811	1.035
TruFLOW Jr. Assembly, B&I, 6-loop	A2660601	15.059	12.215	8.249	1.969	2.9	1.285	0.728	1.763	1.811	1.035
TruFLOW Jr. Assembly, B&I, 7-loop	A2660701	17.028	12.214	8.248	1.969	2.9	1.285	0.728	1.763	1.811	1.035
TruFLOW Jr. Assembly, B&I, 8-loop	A2660801	18.996	12.214	8.248	1.969	2.9	1.285	0.728	1.763	1.811	1.035

Part name	Part no.	Weight per UOM [lbs/UOM]
TruFLOW Jr. Assembly, B&I, 2-loop	A2660201	5.78
TruFLOW Jr. Assembly, B&I, 3-loop	A2660301	7.86
TruFLOW Jr. Assembly, B&I, 4-loop	A2660401	9.95
TruFLOW Jr. Assembly, B&I, 5-loop	A2660501	12.67
TruFLOW Jr. Assembly, B&I, 6-loop	A2660601	14.76
TruFLOW Jr. Assembly, B&I, 7-loop	A2660701	16.84
TruFLOW Jr. Assembly, B&I, 8-loop	A2660801	18.93

## Installation

TruFLOW Jr. Manifolds are fully assembled ready for installation. Use the TruFLOW Balancing Hex Key on the internal balancing valves of the supply manifold. The manifold is shipped with the appropriate number of actuator adapters (A2630028). Refer to the Uponor TruFLOW Jr. Manifold Instruction Sheet for further information.

## Related applications

Radiant Heating and Cooling Systems  
Permafrost Prevention Systems  
Turf Conditioning Systems

## Codes

IMC|IRC|NBC of Canada|UMC

## Standards

CSA B137.5|R32: ISO 228-G 1 1/4"|ASTM F877|R20: ISO 228-G 3/4"

## Listings

cNSFus-rfh

## Notes

Manifold body threaded connections:  
R32  
Manifold loop threaded connections: R20

Uponor Inc.  
5925 148th Street West  
Apple Valley, MN 55124  
T 800.321.4739  
F 952.891.2008

Uponor Ltd.  
6510 Kennedy Road  
Mississauga, ON L5T 2X4  
T 888.594.7726  
F 800.636.9517

---