

ProPEX lead-free (LF) copper straight stubs

Project information

Job name:	Location:
Engineer:	Date submitted:
Contractor:	Submitted by:
Manufacturer's representative:	Approved by:

Technical data

Material	Copper
Subcomponent Material	LF Brass
	Copper
End type 1	ProPEX 1/2"
End type 2	Copper 1/2"
Temp/pressure ratings	73 °F (23 °C) at 160 psi (11 bar)
	180 °F (82 °C) at 100 psi (6.9 bar)
	200 °F (93 °C) at 80 psi (5.5 bar)
Prop 65 label required?	Yes

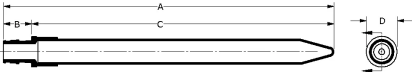

Product information and application use

ProPEX® Lead-free (LF) Copper Straight Stub transitions Uponor PEX tubing to copper pipe for use in hot and cold domestic potable water systems and hydronic radiant heating and cooling systems. 1 The transition fitting can be used for direct transition to copper sweat, copper press and roll-groove applications. The transition fitting is safe for direct burial in soil.

Note: Temperature and pressure ratings stated are hydrostatic ratings. For domestic hot-water (DHW) and DHW recirculation installations, operating conditions should not exceed 140°F (60°C) at 80 psi (5.5 bar) in accordance with ASTM F2023. For additional information regarding application-specific temperature and pressure ratings, refer to the Uponor PEX Piping Systems Design and Installation Manual.

Part name	Part no.	A [mm]	B [mm]	C [mm]	D [mm]	Weight per UOM [kg/UOM]
ProPEX LF Copper Straight Stub, 1/2" PEX LF Brass x 1/2" Copper (8")	LF2935050	210.83	18	192.83	19.56	0.101
ProPEX LF Copper Straight Stub, 1/2" PEX LF Brass x 1/2" Copper (15")	LF2945050	368.31	18	350.31	19.56	0.181

Part name	Part no.	Codes	Standards	Listings
ProPEX lead-free (LF) copper straight stubs	All	UPC IBC IRC IPC NPC of Canada UMC NSPC IMC	NSF/ANSI/CAN 372 ASTM F877 ASTM F1960 CSA B137.5 NSF/ANSI/CAN 61 NSF/ANSI 14	IAPMO-ES HUD MR 1269

In addition, the following parts have additional codes, standards, or listings:

ProPEX LF Copper Straight Stub, 1/2" PEX LF Brass x 1/2" Copper (15")	LF2945050
---	-----------

Installation

Use the appropriate Uponor ProPEX Ring for the tubing (sold separately). Do not solder within 18 inches of the ProPEX fitting. Refer to the Uponor AquaPEX® Professional Plumbing Installation Guide or Uponor Hydronic Piping Design Assistance Manual for additional information.

Related applications

- PEX-a Plumbing Systems
- Hydronic Radiant Heating and Cooling Systems
- Snow Melting Systems
- Turf Conditioning Systems
- Permafrost Prevention Systems

Footnotes

Contact information

-	Uponor Inc. 5925 148th Street West Apple Valley, MN 55124 T 800.321.4739 F 952.891.2008	Uponor Ltd. 6510 Kennedy Road Mississauga, ON L5T 2X4 T 888.594.7726 F 800.638.9517
---	---	---