

# ProPEX EP reducing tees - up to 1.5in

## Project Information

Job name :	Location :
Engineer :	Date submitted:
Contractor :	Submitted by:
Manufacturer's representative :	Approved by :

## Technical data

Material	Engineered Polymer
Temp/pressure ratings	73 °F (23 °C) at 160 psi (11 bar) 180 °F (82 °C) at 100 psi (6.9 bar) 200 °F (93 °C) at 80 psi (5.5 bar)
Prop 65 label required?	No

## Product information and application use

ProPEX® engineered polymer (EP) reducing tees make diverting connections for Uponor crosslinked polyethylene (PEX-a) tubing for use in hot and cold domestic potable water systems, residential fire sprinkler systems and hydronic radiant heating and cooling systems. Each end of the tee is manufactured with an Uponor ProPEX fitting for connections to Uponor AquaPEX® or Wirsbo hePEX™ tubing.1 Note: Branch size is listed last in the part descriptions.

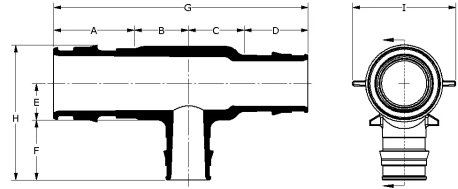

Related: [ProPEX EP reducing tees - 2in and up](#)

Part name	Part no.	A [inch]	B [inch]	C [inch]	D [inch]	E [inch]	F [inch]	G [inch]	H [inch]	I [inch]	Cv
ProPEX EP Reducing Tee, 1" PEX x 1" PEX x 1 1/4" PEX	Q4751113	1.191	1	1	1.191	0.9	1.455	4.382	2.945	1.82	-
ProPEX EP Reducing Tee, 1" PEX x 1" PEX x 1/2" PEX	Q4751150	1.191	0.7	0.7	1.191	0.65	0.719	3.782	1.959	1.48	-
ProPEX EP Reducing Tee, 1" PEX x 1" PEX x 3/4" PEX	Q4751175	1.191	0.85	0.85	1.191	0.65	0.955	4.082	2.195	1.48	-
ProPEX EP Reducing Tee, 1 1/4" PEX x 1" PEX x 1" PEX	Q4751311	1.455	1.03	1.03	1.191	0.75	1.191	4.706	2.622	1.82	-
ProPEX EP Reducing Tee, 1 1/4" PEX x 1" PEX x 3/4" PEX	Q4751317	1.455	0.925	0.925	1.191	0.75	0.955	4.496	2.386	1.82	-
ProPEX EP Reducing Tee, 1 1/4" PEX x 1 1/4" PEX x 1" PEX	Q4751331	1.455	1.03	1.03	1.455	0.75	1.191	4.97	2.622	1.82	-
ProPEX EP Reducing Tee, 1 1/4" PEX x 1 1/4" PEX x 3/4" PEX	Q4751337	1.455	0.9	0.9	1.455	0.75	0.955	4.71	2.386	1.82	-
ProPEX EP Reducing Tee, 1 1/4" PEX x 1 1/4" PEX x 1/2" PEX	Q4751350	1.455	0.75	0.75	1.455	0.83	0.719	4.41	2.199	1.82	-
ProPEX EP Reducing Tee, 1 1/4" PEX x 3/4" PEX x 1" PEX	Q4751371	1.455	1.06	0.9	0.955	0.75	1.191	4.37	2.622	1.82	-
ProPEX EP Reducing Tee, 1 1/4" PEX x 3/4" PEX x 1 1/4" PEX	Q4751373	1.455	1.2	1	0.955	0.75	1.455	4.61	2.886	1.82	-
ProPEX EP Reducing Tee, 1 1/4" PEX x 3/4" PEX x 3/4" PEX	Q4751377	1.455	0.9	0.8	0.955	0.75	0.955	4.11	2.386	1.82	-
ProPEX EP Reducing Tee, 1" PEX x 1/2" PEX x 1" PEX	Q4751501	1.191	1	0.8	0.719	0.65	1.191	3.71	2.431	1.48	-
ProPEX EP Reducing Tee, 1 1/2" PEX x 1" PEX x 1 1/2" PEX	Q4751505	1.714	1.25	1.25	1.191	0.94	1.714	5.405	3.434	2.07	-
ProPEX EP Reducing Tee, 1 1/2" PEX x 1" PEX x 1" PEX	Q4751511	1.714	1.1	1.1	1.191	0.9	1.191	5.105	2.839	2.07	-
ProPEX EP Reducing Tee, 1 1/2" PEX x 1" PEX x 3/4" PEX	Q4751517	1.714	1.17	1.17	1.191	1.11	0.955	5.245	3.064	1.998	-
ProPEX EP Reducing Tee, 1 1/2" PEX x 1 1/4" PEX x 1" PEX	Q4751531	1.714	1.05	1.05	1.455	0.85	1.191	5.269	2.789	2.07	-
ProPEX EP Reducing Tee, 1 1/2" PEX x 1 1/4" PEX x 1 1/4" PEX	Q4751533	1.714	1.15	1.15	1.455	0.85	1.455	5.469	3.052	2.07	-
ProPEX EP Reducing Tee, 1 1/2" PEX x 1 1/4" PEX x 3/4" PEX	Q4751537	1.714	0.9	0.9	1.455	0.85	0.955	4.969	2.552	2.07	-
ProPEX EP Reducing Tee, 1 1/2" PEX x 1 1/2" PEX x 1/2" PEX	Q4751550	1.714	0.75	0.75	1.714	0.83	0.719	4.928	2.299	2.07	-
ProPEX EP Reducing Tee, 1 1/2" PEX x 1 1/2" PEX x 1" PEX	Q4751551	1.714	1	1	1.714	0.85	1.191	5.428	2.791	2.07	-

ProPEX EP Reducing Tee, 1 1/2" PEX x 1 1/2" PEX x 1 1/4" PEX	Q4751553	1.714	1.15	1.15	1.714	0.85	1.455	5.728	3.055	2.07	-
ProPEX EP Reducing Tee, 1 1/2" PEX x 1 1/2" PEX x 3/4" PEX	Q4751557	1.714	0.925	0.925	1.714	0.85	0.955	5.278	2.555	2.07	-
ProPEX EP Reducing Tee, 1 1/2" PEX x 3/4" PEX x 1 1/2" PEX	Q4751575	1.714	1.3	1	0.955	0.9	1.714	4.969	3.394	2.07	-
ProPEX EP Reducing Tee, 1 1/2" PEX x 3/4" PEX x 3/4" PEX	Q4751577	1.714	0.9	0.8	0.955	0.9	0.955	4.369	2.635	2.07	-
ProPEX EP Reducing Tee, 1" PEX x 3/4" PEX x 1/2" PEX	Q4751750	1.191	0.75	0.75	0.955	0.65	0.719	3.646	1.959	1.48	-
ProPEX EP Reducing Tee, 1" PEX x 3/4" PEX x 1" PEX	Q4751751	1.191	0.925	0.925	0.955	0.65	1.191	3.996	2.431	1.48	-
ProPEX EP Reducing Tee, 1" PEX x 3/4" PEX x 1 1/4" PEX	Q4751753	1.191	1	1	0.955	0.9	1.455	4.146	2.945	1.82	-
ProPEX EP Reducing Tee, 1" PEX x 3/4" PEX x 3/4" PEX	Q4751775	1.191	0.775	0.775	0.955	0.65	0.955	3.696	2.195	1.48	-
ProPEX EP Reducing Tee, 1/2" PEX x 1/2" PEX x 3/4" PEX	Q4755575	0.719	0.71	0.71	0.719	0.5	0.955	2.858	1.765	0.87	-
ProPEX EP Reducing Tee, 3/4" PEX x 3/4" PEX x 1/2" PEX	Q4757550	0.955	0.69	0.69	0.955	0.54	0.719	3.29	1.696	1.22	-
ProPEX EP Reducing Tee, 3/4" PEX x 1/2" PEX x 1/2" PEX	Q4757555	0.955	0.7	0.7	0.719	0.52	0.719	3.074	1.676	1.22	-
ProPEX EP Reducing Tee, 3/4" PEX x 1/2" PEX x 3/4" PEX	Q4757557	0.955	0.7	0.7	0.719	0.52	0.955	3.074	1.913	1.22	-
ProPEX EP Reducing Tee, 3/4" PEX x 3/4" PEX x 5/8" PEX	Q4757563	0.955	0.69	0.69	0.955	0.54	0.876	3.29	1.856	1.18	-
ProPEX EP Reducing Tee, 3/4" PEX x 3/4" PEX x 1" PEX	Q4757710	0.955	0.865	0.865	0.955	0.69	1.191	3.64	1.881	1.18	2.6

Part name	Part no.	Cv Through	Weight per UOM [lbs/UOM]	Equivalent length branch [ft]	Equivalent length through [ft]	Cv Branch	End Type 1	End Type 2	End Type 3
ProPEX EP Reducing Tee, 1" PEX x 1" PEX x 1 1/4" PEX	Q4751113	15	0.13	6.5	1.2	-	ProPEX 1"	ProPEX 1"	ProPEX 1-1/4"
ProPEX EP Reducing Tee, 1" PEX x 1" PEX x 1/2" PEX	Q4751150	32.2	0.08	6.5	1.2	-	ProPEX 1"	ProPEX 1"	ProPEX 1/2"
ProPEX EP Reducing Tee, 1" PEX x 1" PEX x 3/4" PEX	Q4751175	27.8	0.09	6.4	1.7	-	ProPEX 1"	ProPEX 1"	ProPEX 3/4"
ProPEX EP Reducing Tee, 1 1/4" PEX x 1" PEX x 1" PEX	Q4751311	11.7	0.12	23	11	-	ProPEX 1-1/4"	ProPEX 1"	ProPEX 1"
ProPEX EP Reducing Tee, 1 1/4" PEX x 1" PEX x 3/4" PEX	Q4751317	21	0.11	5.2	3.4	-	ProPEX 1-1/4"	ProPEX 1"	ProPEX 3/4"
ProPEX EP Reducing Tee, 1 1/4" PEX x 1 1/4" PEX x 1" PEX	Q4751331	33	0.14	6.3	4.2	-	ProPEX 1-1/4"	ProPEX 1-1/4"	ProPEX 1"
ProPEX EP Reducing Tee, 1 1/4" PEX x 1 1/4" PEX x 3/4" PEX	Q4751337	43.4	0.13	5.7	2.3	-	ProPEX 1-1/4"	ProPEX 1-1/4"	ProPEX 3/4"
ProPEX EP Reducing Tee, 1 1/4" PEX x 1 1/4" PEX x 1/2" PEX	Q4751350	45.2	0.1	3.9	1.9	-	ProPEX 1-1/4"	ProPEX 1-1/4"	ProPEX 1/2"
ProPEX EP Reducing Tee, 1 1/4" PEX x 3/4" PEX x 1" PEX	Q4751371	13.9	0.11	11.91	-	-	ProPEX 1-1/4"	ProPEX 3/4"	ProPEX 1"
ProPEX EP Reducing Tee, 1 1/4" PEX x 3/4" PEX x 1 1/4" PEX	Q4751373	18.8	0.13	7.41	-	-	ProPEX 1-1/4"	ProPEX 3/4"	ProPEX 1-1/4"
ProPEX EP Reducing Tee, 1 1/4" PEX x 3/4" PEX x 3/4" PEX	Q4751377	7.3	0.09	9.7	-	-	ProPEX 1-1/4"	ProPEX 3/4"	ProPEX 3/4"
ProPEX EP Reducing Tee, 1" PEX x 1/2" PEX x 1" PEX	Q4751501	12.3	0.09	14.9	4.2	-	ProPEX 1"	ProPEX 1/2"	ProPEX 1"
ProPEX EP Reducing Tee, 1 1/2" PEX x 1" PEX x 1 1/2" PEX	Q4751505	19	0.2	14.9	4.2	-	ProPEX 1-1/2"	ProPEX 1"	ProPEX 1-1/2"
ProPEX EP Reducing Tee, 1 1/2" PEX x 1" PEX x 1" PEX	Q4751511	18.9	0.18	6.5	4.3	-	ProPEX 1-1/2"	ProPEX 1"	ProPEX 1"
ProPEX EP Reducing Tee, 1 1/2" PEX x 1" PEX x 3/4" PEX	Q4751517	19.5	0.17	5.1	4	-	ProPEX 1-1/2"	ProPEX 1"	ProPEX 3/4"
ProPEX EP Reducing Tee, 1 1/2" PEX x 1 1/4" PEX x 1" PEX	Q4751531	36.4	0.19	13.1	3.1	-	ProPEX 1-1/2"	ProPEX 1-1/4"	ProPEX 1"
ProPEX EP Reducing Tee, 1 1/2" PEX x 1 1/4" PEX x 1 1/4" PEX	Q4751533	45.4	0.21	17.7	2	-	ProPEX 1-1/2"	ProPEX 1-1/4"	ProPEX 1-1/4"
ProPEX EP Reducing Tee, 1 1/2" PEX x 1 1/4" PEX x 3/4" PEX	Q4751537	33.1	0.18	11.3	4.2	-	ProPEX 1-1/2"	ProPEX 1-1/4"	ProPEX 3/4"

ProPEX EP Reducing Tee, 1 1/2" PEX x 1 1/2" PEX x 1/2" PEX	Q4751550	60.5	0.14	6.3	2.4	-	ProPEX 1-1/2"	ProPEX 1-1/2"	ProPEX 1/2"
ProPEX EP Reducing Tee, 1 1/2" PEX x 1 1/2" PEX x 1" PEX	Q4751551	53.8	0.21	6.9	3.1	-	ProPEX 1-1/2"	ProPEX 1-1/2"	ProPEX 1"
ProPEX EP Reducing Tee, 1 1/2" PEX x 1 1/2" PEX x 1 1/4" PEX	Q4751553	54.3	0.22	4.1	3.2	-	ProPEX 1-1/2"	ProPEX 1-1/2"	ProPEX 1-1/4"
ProPEX EP Reducing Tee, 1 1/2" PEX x 1 1/2" PEX x 3/4" PEX	Q4751557	56	0.2	5.4	2.9	-	ProPEX 1-1/2"	ProPEX 1-1/2"	ProPEX 3/4"
ProPEX EP Reducing Tee, 1 1/2" PEX x 3/4" PEX x 1 1/2" PEX	Q4751575	22.9	0.19	7.41	-	-	ProPEX 1-1/2"	ProPEX 3/4"	ProPEX 1-1/2"
ProPEX EP Reducing Tee, 1 1/2" PEX x 3/4" PEX x 3/4" PEX	Q4751577	7.3	0.13	6.69	-	-	ProPEX 1-1/2"	ProPEX 3/4"	ProPEX 3/4"
ProPEX EP Reducing Tee, 1" PEX x 3/4" PEX x 1/2" PEX	Q4751750	3.1	0.07	15.1	2.4	-	ProPEX 1"	ProPEX 3/4"	ProPEX 1/2"
ProPEX EP Reducing Tee, 1" PEX x 3/4" PEX x 1" PEX	Q4751751	12.9	0.08	15.1	2.4	-	ProPEX 1"	ProPEX 3/4"	ProPEX 1"
ProPEX EP Reducing Tee, 1" PEX x 3/4" PEX x 1 1/4" PEX	Q4751753	14.7	0.12	16.7	2.4	-	ProPEX 1"	ProPEX 3/4"	ProPEX 1-1/4"
ProPEX EP Reducing Tee, 1" PEX x 3/4" PEX x 3/4" PEX	Q4751775	12.8	0.08	16.7	2.4	-	ProPEX 1"	ProPEX 3/4"	ProPEX 3/4"
ProPEX EP Reducing Tee, 1/2" PEX x 1/2" PEX x 3/4" PEX	Q4755575	7.7	0.03	15.6	1	-	ProPEX 1/2"	ProPEX 1/2"	ProPEX 3/4"
ProPEX EP Reducing Tee, 3/4" PEX x 3/4" PEX x 1/2" PEX	Q4757550	14.2	0.04	7.6	2	-	ProPEX 3/4"	ProPEX 3/4"	ProPEX 1/2"
ProPEX EP Reducing Tee, 3/4" PEX x 1/2" PEX x 1/2" PEX	Q4757555	4.6	0.04	6.4	3.5	-	ProPEX 3/4"	ProPEX 1/2"	ProPEX 1/2"
ProPEX EP Reducing Tee, 3/4" PEX x 1/2" PEX x 3/4" PEX	Q4757557	5.4	0.04	16.1	2.3	-	ProPEX 3/4"	ProPEX 1/2"	ProPEX 3/4"
ProPEX EP Reducing Tee, 3/4" PEX x 3/4" PEX x 5/8" PEX	Q4757563	15.7	0.05	15.6	1.5	-	ProPEX 3/4"	ProPEX 3/4"	ProPEX 5/8"
ProPEX EP Reducing Tee, 3/4" PEX x 3/4" PEX x 1" PEX	Q4757710	15.7	0.08	5.76	1.5	-	ProPEX 3/4"	ProPEX 3/4"	ProPEX 1"

#### Installation

Use the appropriate ProPEX ring for PEX-a tubing. Refer to the Uponor Piping Pocket Guide, AquaSAFE™ Residential Fire Sprinkler Installation Guide or Uponor Radiant Installation Handbook for additional information.

#### Related applications

PEX-a Plumbing Systems  
Hydronic Radiant Heating and Cooling Systems  
Turf Conditioning Systems  
Permafrost Prevention Systems

#### Codes

IMC|UPC|IBC|IRC|IPC|NPC of Canada|UMC\*

#### Standards

ASTM F1960|ASTM E119/UL 263|ASTM E84|ASTM E814/ULC S115|ASTM F877|CSA B137.5|ULC S102.2|NSF-61|ULC S101|NSF-14\*

#### Listings

IAPMO-ES|ICC-ES-PMG|cNSFus-pw|UL|U.P.Code|cQAlus P321|HUD MR 1269\*

#### Footnotes

-  
\* Some SKUs in this family have additional codes, standards, or listings. Please see uponor.com for complete information.

#### Contact information

Uponor Inc.  
5925 148th Street West  
Apple Valley, MN 55124  
T 800.321.4739  
F 952.891.2008

Uponor Ltd.  
6510 Kennedy Road  
Mississauga, ON L5T 2X4  
T 888.594.7726  
F 800.636.9517