

Uponor Meltaway coupling 25x2,3 156mm

1033672

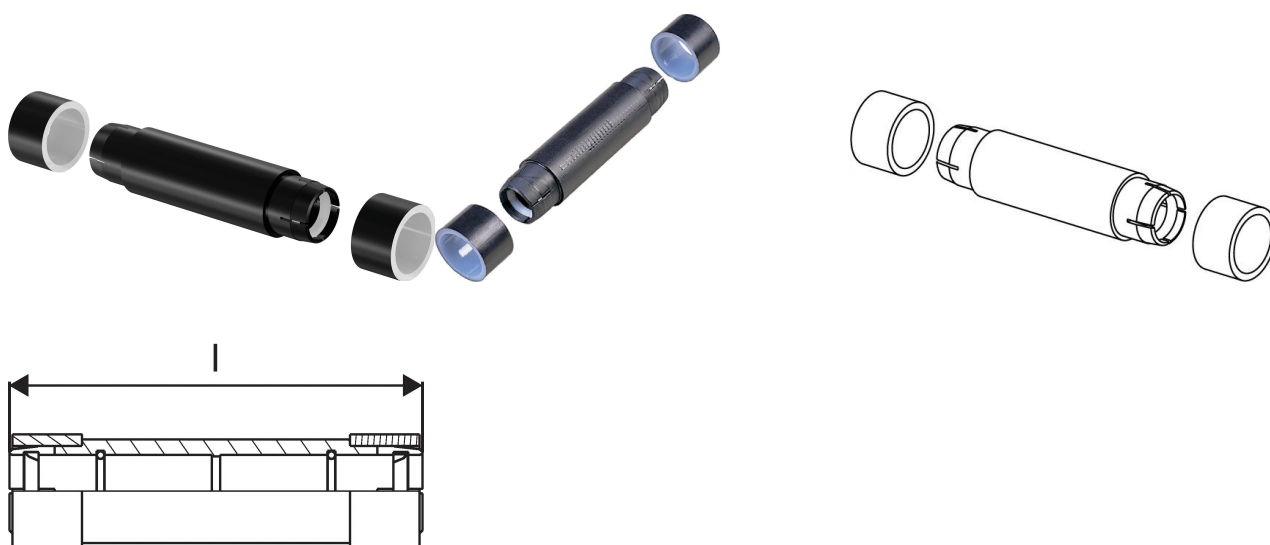

Application information Uponor Meltaway coupling

Specification

- snow- and ice melting system for areas with solid ground covering
- Made of high density polyethylene (HDPE) pipe
- Equipped with compact-welded couplings oriented in two directions with an angle of 120° between them

Application

- outdoor surface warming
- snow and ice melting

Uponor Meltaway coupling 25x2,3 156mm

1033672

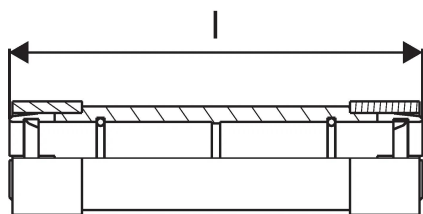
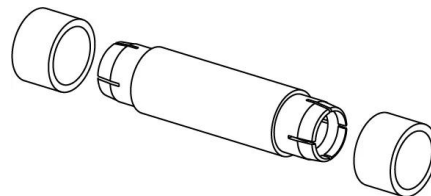
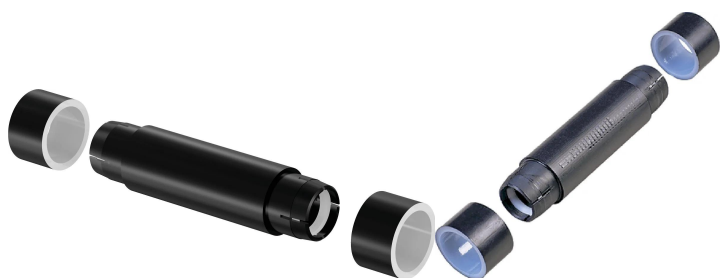

Documents

Page with all documents



Uponor Corporation

Ilmalantori 4
00240, Helsinki
Finland

T +358 (0)20 129 211

www.uponor.com