

Uponor S-Press PLUS elbow swivel nut 16-G3/4"SN

1105818

- Made of tin-plated DR brass
- Releasable screw connector for connection to on-wall fittings, filters and shut-off valves
- Thread acc. to EN ISO 228-1.

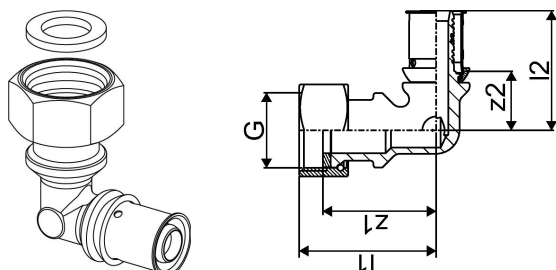

Application information Uponor S-Press PLUS elbow swivel nut

Specification

- Unique press indicator
- Fast 3-step installation (press without bevel)
- Innovative QR code for immediate digital access
- Colour code
- Fixed press sleeve with inspection window
- Precise jaw fixation
- Fast diameter recognition
- Accurate test safety function
- 100% backward compatible with existing Uponor components
- Flow rate optimized fitting body

Application

- Tap water: The permanent operating temperature ranges from 0°C to 70°C at a maximum permanent operating pressure of 10 bar. The short-term malfunction temperature is 95°C for a period of 100 hours in the operating life time.
- Heating: The permanent operating temperature ranges up to 80°C at a maximum permanent operating pressure of 10 bar. The short-term malfunction temperature is 100°C for a period of 100 hours in the operating life time.

if not different mentioned:

- Male and female threads acc.to EN 10226-1.

Certification

- Approvals by local OM.

E.g.

- DVGW
- AENOR

Uponor S-Press PLUS elbow swivel nut 16-G3/4"SN

1105818

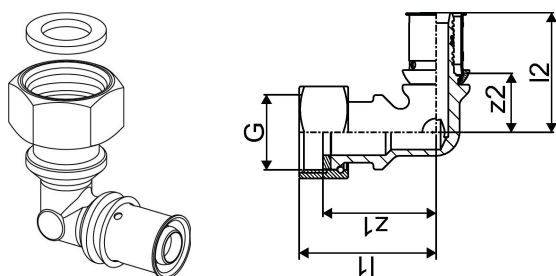

Technical data

Item (unit of measurement) pce

Item no LVI 1720851

Length (l1) 45 mm

Length (l2) 39 mm

Z-measurement z2 19 mm

Packaging Quantity PL1 1

Packaging Quantity PL2 10

Packaging Quantity PL4 1920

Documents

Page with all documents



Uponor Corporation

Ilmalantori 4
00240, Helsinki
Finland

T +358 (0)20 129 211
E info@uponor.com
F +358 (0)20 129 2841

www.uponor.com