

GF Silenta premium double branch 45deg 160-110mm

1146411

- drainage branch fitting made of reinforced plastic
- optimized flow geometry
- low noise drainage design
- suitable for wastewater systems

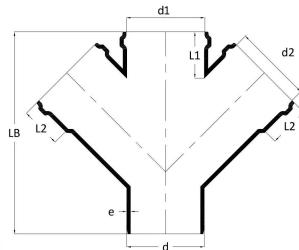

Application information GF Silenta premium double branch 45deg

Specification

- Three-layer polypropylene pipe system manufactured according to EN 1451
- Sound-insulated construction with enhanced mechanical strength
- Pipe diameter range: DN 58 to DN 200
- High chemical and temperature resistance
- Complete system including pipes, fittings and accessories

Application

- Residential buildings and apartment complexes
- Hotels, hospitals, schools and office buildings
- Sustainable and green buildings
- Industrial facilities (short and long-term wastewater use)
- Domestic sewage systems
- Wastewater from kitchens, bathrooms, laundry rooms and sanitary areas

GF Silenta premium double branch 45deg 160-110mm

1146411

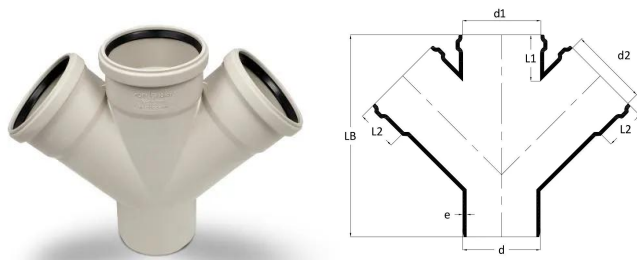

Status

Item Available From date 2026-02-01

Product code

| | |
|--------------|----------------|
| Item no EAN | 8698652133966 |
| Item no GF | 4501216030521 |
| Item no GTIN | 08698652133966 |
| Item no VVS | 186848197 |

Dimensions

| | |
|------------------|-------|
| Item Unit Height | 320 |
| Item Unit Length | 188 |
| Item Unit Weight | 2,402 |
| Item Unit Width | 428 |
| Item_UOM | pce |

Measurements

| | |
|------------------|-----|
| Length (l2) | 63 |
| Z Measurement d2 | 110 |
| Z Measurement e | 5,3 |

Packaging

| | |
|------------------------|----------------|
| Packaging GTIN PL1 | 06414900554725 |
| Packaging GTIN PL2 | 06414900050975 |
| Packaging GTIN PL4 | 06414900215428 |
| Packaging Height PL1 | 320 |
| Packaging Height PL2 | 360 |
| Packaging Height PL4 | 1200 |
| Packaging Length PL1 | 188 |
| Packaging Length PL2 | 590 |
| Packaging Length PL4 | 1200 |
| Packaging Quantity PL1 | 1 |

| | |
|------------------------|------------|
| Packaging Quantity PL2 | 3 |
| Packaging Quantity PL4 | 36 |
| Packaging Type PL1 | Piece |
| Packaging Type PL2 | Medium_Box |
| Packaging Type PL4 | Pallet |
| Packaging Volume PL1 | 0,02574848 |
| Packaging Volume PL2 | 0,082836 |
| Packaging Volume PL4 | 1,152 |
| Packaging Weight PL1 | 2,402 |
| Packaging Weight PL2 | 7,206 |
| Packaging Weight PL4 | 111,472 |
| Packaging Width PL1 | 428 |
| Packaging Width PL2 | 390 |
| Packaging Width PL4 | 800 |

Documents

Page with all documents 

Uponor Corporation

Ilmalantori 4
00240, Helsinki
Finland

T +358 (0)20 129 211

www.uponor.com