

## GF HT-PP elbow 87,5deg 40mm

1150128

- Gray, PP-material, according to EN 1451

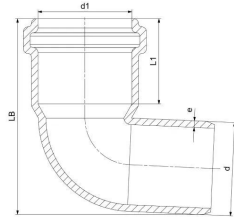

### Application information GF HT-PP elbow 87,5deg

#### Specification

- The system is made from monolayer polypropylene (PP) to ensure reliable performance in standard drainage applications.
- It is designed for non-pressurized soil and wastewater drainage in residential and commercial buildings.
- The system is fully compliant with EN 1451-1 for plastic soil and waste discharge and EN 13501 for fire classification.
- It achieves fire performance rating E according to EN 13501.
- The pipes are suitable for short-term exposure to high-temperature wastewater.
- The material provides high resistance to chemicals commonly found in domestic and commercial wastewater.
- The push-fit socket design with integrated sealing rings ensures quick installation and leak-tight connections.
- The system is available in nominal diameters ranging from DN 32 to DN 200.

#### Application

- Residential buildings
- Office buildings and conference facilities
- Schools, libraries, hospitals, and hotels
- Underground and above-ground house drainage
- Sustainable / green building projects
- Industrial facilities (short- and long-term use)
- Wastewater from kitchens, bathrooms, and household appliances (e.g. washing machines, dishwashers)

## GF HT-PP elbow 87,5deg 40mm

1150128



### Status

Item Available From date

2026-02-01

### Product code

Item no EAN 8698652043135

Item no GF 4901104001321

Item no GTIN 08698652043135

Item no VVS 186114040

### Dimensions

Item Unit Height 80

Item Unit Length 55

Item Unit Weight 0,046

Item Unit Width 120

Item\_UOM pce

### Packaging

Packaging GTIN PL1 06414900601566

Packaging GTIN PL2 06414900230926

Packaging GTIN PL4 06414900103701

Packaging Height PL1 80

Packaging Height PL2 400

Packaging Height PL4 1200

Packaging Length PL1 55

Packaging Length PL2 800

Packaging Length PL4 1200

Packaging Quantity PL1 1

Packaging Quantity PL2 500

Packaging Quantity PL4 3000

Packaging Type PL1 Piece

Packaging Type PL2 Medium\_Box

Packaging Type PL4	Pallet
Packaging Volume PL1	0,000528
Packaging Volume PL2	0,192
Packaging Volume PL4	1,44
Packaging Weight PL1	0,046
Packaging Weight PL2	23
Packaging Weight PL4	163
Packaging Width PL1	120
Packaging Width PL2	600
Packaging Width PL4	1000

## Documents

Page with all documents 

### Uponor Corporation

Ilmalantori 4  
00240, Helsinki  
Finland

T +358 (0)20 129 211

[www.uponor.com](http://www.uponor.com)