

## GF HT-PP double branch 45deg 50-50mm

**1150155**

- Gray, PP-material, according to EN 1451

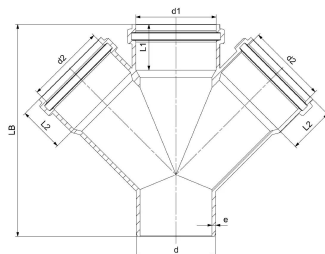

### Application information GF HT-PP double branch 45deg

#### Specification

- The system is made from monolayer polypropylene (PP) to ensure reliable performance in standard drainage applications.
- It is designed for non-pressurized soil and wastewater drainage in residential and commercial buildings.
- The system is fully compliant with EN 1451-1 for plastic soil and waste discharge and EN 13501 for fire classification.
- It achieves fire performance rating E according to EN 13501.
- The pipes are suitable for short-term exposure to high-temperature wastewater.
- The material provides high resistance to chemicals commonly found in domestic and commercial wastewater.
- The push-fit socket design with integrated sealing rings ensures quick installation and leak-tight connections.
- The system is available in nominal diameters ranging from DN 32 to DN 200.

#### Application

- Residential buildings
- Office buildings and conference facilities
- Schools, libraries, hospitals, and hotels
- Underground and above-ground house drainage
- Sustainable / green building projects
- Industrial facilities (short- and long-term use)
- Wastewater from kitchens, bathrooms, and household appliances (e.g. washing machines, dishwashers)

## GF HT-PP double branch 45deg 50-50mm

1150155



### Status

Item Available From date

2026-02-01

### Product code

Item no EAN 8698652042367

Item no GF 4901205012021

Item no GTIN 08698652042367

Item no VVS 186416050

### Dimensions

Item Unit Height 175

Item Unit Length 65

Item Unit Weight 0,118

Item Unit Width 195

Item\_UOM pce

### Packaging

Packaging GTIN PL1 06414900553445

Packaging GTIN PL2 06414900231190

Packaging GTIN PL4 06414900104517

Packaging Height PL1 175

Packaging Height PL2 400

Packaging Height PL4 1200

Packaging Length PL1 65

Packaging Length PL2 800

Packaging Length PL4 1200

Packaging Quantity PL1 1

Packaging Quantity PL2 100

Packaging Quantity PL4 600

Packaging Type PL1 Piece

Packaging Type PL2 Medium\_Box

Packaging Type PL4	Pallet
Packaging Volume PL1	0,002218125
Packaging Volume PL2	0,192
Packaging Volume PL4	1,152
Packaging Weight PL1	0,118
Packaging Weight PL2	11,8
Packaging Weight PL4	95,8
Packaging Width PL1	195
Packaging Width PL2	600
Packaging Width PL4	800

## Documents

Page with all documents



### Uponor Corporation

Ilmalantori 4  
00240, Helsinki  
Finland

T +358 (0)20 129 211

[www.uponor.com](http://www.uponor.com)