

GF HT-PP double branch 45deg 75-50mm

1150161

- Gray, PP-material, according to EN 1451

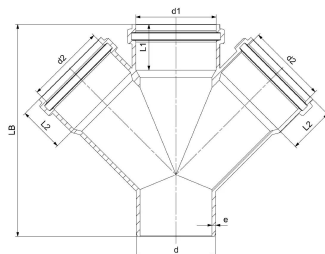

Application information GF HT-PP double branch 45deg

Specification

- The system is made from monolayer polypropylene (PP) to ensure reliable performance in standard drainage applications.
- It is designed for non-pressurized soil and wastewater drainage in residential and commercial buildings.
- The system is fully compliant with EN 1451-1 for plastic soil and waste discharge and EN 13501 for fire classification.
- It achieves fire performance rating E according to EN 13501.
- The pipes are suitable for short-term exposure to high-temperature wastewater.
- The material provides high resistance to chemicals commonly found in domestic and commercial wastewater.
- The push-fit socket design with integrated sealing rings ensures quick installation and leak-tight connections.
- The system is available in nominal diameters ranging from DN 32 to DN 200.

Application

- Residential buildings
- Office buildings and conference facilities
- Schools, libraries, hospitals, and hotels
- Underground and above-ground house drainage
- Sustainable / green building projects
- Industrial facilities (short- and long-term use)
- Wastewater from kitchens, bathrooms, and household appliances (e.g. washing machines, dishwashers)

GF HT-PP double branch 45deg 75-50mm

1150161



Status

Item Available From date

2026-02-01

Product code

Item no EAN

8698652042374

Item no GF

4901207513021

Item no GTIN

08698652042374

Item no VVS

186416073

Dimensions

Item Unit Height

180

Item Unit Length

90

Item Unit Weight

0,14

Item Unit Width

220

Item_UOM

pce

Packaging

Packaging GTIN PL1

06414900602167

Packaging GTIN PL2

06414900231251

Packaging GTIN PL4

06414900104630

Packaging Height PL1

180

Packaging Height PL2

400

Packaging Height PL4

1200

Packaging Length PL1

90

Packaging Length PL2

800

Packaging Length PL4

1200

Packaging Quantity PL1

1

Packaging Quantity PL2

80

Packaging Quantity PL4

480

Packaging Type PL1

Piece

Packaging Type PL2

Medium_Box

Packaging Type PL4	Pallet
Packaging Volume PL1	0,003564
Packaging Volume PL2	0,192
Packaging Volume PL4	1,152
Packaging Weight PL1	0,14
Packaging Weight PL2	11,2
Packaging Weight PL4	92,2
Packaging Width PL1	220
Packaging Width PL2	600
Packaging Width PL4	800

Documents

Page with all documents



Uponor Corporation

Ilmalantori 4
00240, Helsinki
Finland

T +358 (0)20 129 211

www.uponor.com