

GF HT-PP double branch 87,5deg 110-110mm

1150169

- Gray, PP-material, according to EN 1451

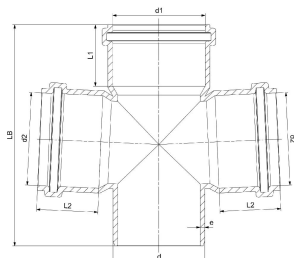

Application information GF HT-PP double branch 87,5deg

Specification

- The system is made from monolayer polypropylene (PP) to ensure reliable performance in standard drainage applications.
- It is designed for non-pressurized soil and wastewater drainage in residential and commercial buildings.
- The system is fully compliant with EN 1451-1 for plastic soil and waste discharge and EN 13501 for fire classification.
- It achieves fire performance rating E according to EN 13501.
- The pipes are suitable for short-term exposure to high-temperature wastewater.
- The material provides high resistance to chemicals commonly found in domestic and commercial wastewater.
- The push-fit socket design with integrated sealing rings ensures quick installation and leak-tight connections.
- The system is available in nominal diameters ranging from DN 32 to DN 200.

Application

- Residential buildings
- Office buildings and conference facilities
- Schools, libraries, hospitals, and hotels
- Underground and above-ground house drainage
- Sustainable / green building projects
- Industrial facilities (short- and long-term use)
- Wastewater from kitchens, bathrooms, and household appliances (e.g. washing machines, dishwashers)

GF HT-PP double branch 87,5deg 110-110mm

1150169

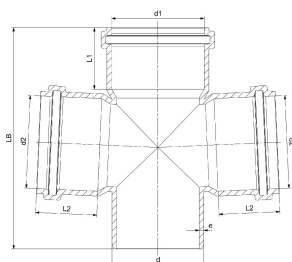

Status

Item Available From date

2026-02-01

Product code

Item no EAN	8698652032092
Item no GF	4901211014121
Item no GTIN	08698652032092
Item no VVS	186411110

Dimensions

Item Unit Height	241
Item Unit Length	130
Item Unit Weight	0,811
Item Unit Width	268
Item_UOM	pce

Packaging

Packaging GTIN PL1	06414900554428
Packaging GTIN PL2	06414900231336
Packaging GTIN PL4	06414900104807
Packaging Height PL1	241
Packaging Height PL2	400
Packaging Height PL4	1200
Packaging Length PL1	130
Packaging Length PL2	800
Packaging Length PL4	1200
Packaging Quantity PL1	1
Packaging Quantity PL2	20
Packaging Quantity PL4	120
Packaging Type PL1	Piece
Packaging Type PL2	Medium_Box

Packaging Type PL4	Pallet
Packaging Volume PL1	0,00839644
Packaging Volume PL2	0,192
Packaging Volume PL4	1,44
Packaging Weight PL1	0,811
Packaging Weight PL2	16,22
Packaging Weight PL4	122,32
Packaging Width PL1	268
Packaging Width PL2	600
Packaging Width PL4	1000

Documents

Page with all documents 

Uponor Corporation

Ilmalantori 4
00240, Helsinki
Finland

T +358 (0)20 129 211

www.uponor.com