

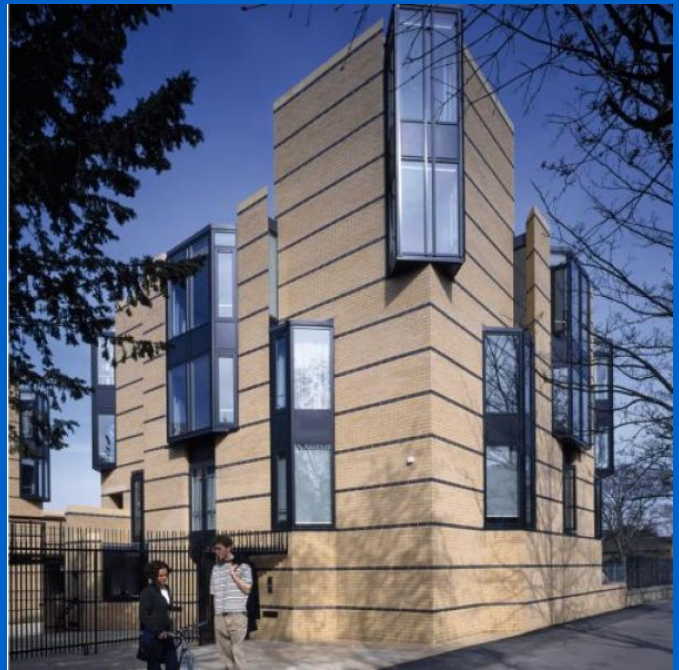

References

## Balliol College, Jowett Walk.



### Uponor involvement



0

## Balliol College, Jowett Walk.

Balliol College, Oxford, 65 apartments have been installed with Uponor Quick & Easy Plumbing.

### Project Facts:

Location

Oxford, United Kingdom

Completion

2006

Building Type

Single family home

Product systems

Multilayer Pipe Systems

Project Type

New building

## Partners

developer  
Oxford University

architect  
MacCormac Jamieson Prichard

installer  
F.G. Alden Ltd

---

Uponor Quick & Easy has recently been recognised as the thinking man's solution to flexible plumbing, by being installed at Oxford University's Balliol College. The College has recently added to its accommodation facilities with the construction of the Jowett Walk Building (JWD), which was designed by London-based architects MacCormac Jamieson Prichard, and includes a total of nine towers that will house bedrooms, seminar/social rooms and a host of other amenities.

The first stage of this prestigious project was the construction of three towers housing sixty-five bedrooms, with Uponor Ltd Quick & Easy pipes used to distribute heating to radiators throughout - meaning that thousands of metres of the cross-linked polyethylene pipe has been used during development. Uponor Quick & Easy PEX pipe was chosen for its flexible, light and easy-to-handle properties. The fact that installers did not have to use heat guns, naked flames or tricky-to-fit rubber seals meant that the time needed to complete the job was significantly reduced.

### Balliol College, Jowett Walk.





GF Building Flow Solutions

Headquarter:  
Ilmalantori 4  
00240 Helsinki  
Finland

Phone +358 20 129 211  
Contact us

Email for communication  
requests: [communications@georgfischer.com](mailto:communications@georgfischer.com)  
Contact for Headquarter, PR, Offices in  
Australia, Dubai, International Sales and for  
Singapore

W [www.uponor.com](http://www.uponor.com)