

## Uponor Smart Radi compr. connection set Oventrop 16-G1/2"MT

**1014016**

- Made of coated brass
- pressure screw with male thread, with inner sleeve and clamp ring, fit to Oventrop radiator valves with female thread
- O-Ring, black, made of EPDM.

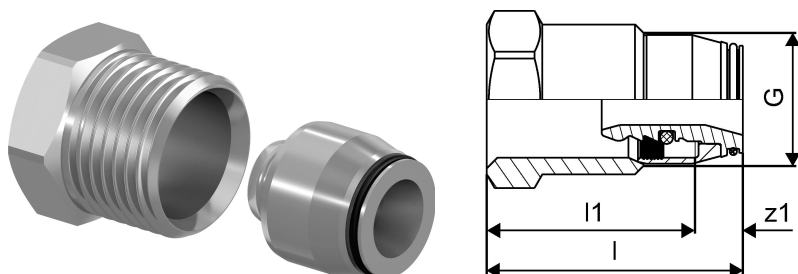

### About Uponor Smart Radi compr. connection set Oventrop

#### Specification

- Fittings and accessories for radiator connection
- Q&E rings must be ordered separately if not different mentioned

#### Application

- Heating with high and with low tempertaure radiators

## Uponor Smart Radi compr. connection set Oventrop 16-G1/2"MT

1014016

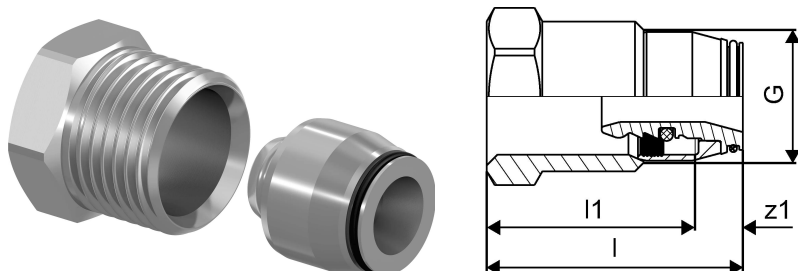

### Technical documents

Download documents here 

#### Uponor UK

Blackmor Lane The Pavilion  
WD18 8GA, Watford  
UK

T +44 (0)1923 927000  
E [enquiries.uk@uponor.com](mailto:enquiries.uk@uponor.com)

[www.uponor.com/en-gb](http://www.uponor.com/en-gb)