

## Uponor Aqua Ambient shower inlet grate plain / silver 700mm

**1136428**

- grate design: plain
- compatible to shower inlets "silver"
- material: polished stainless steel

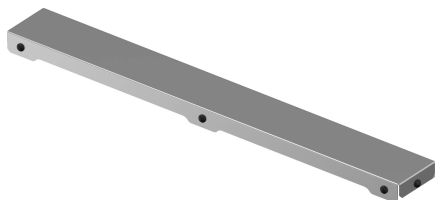

### About Uponor Aqua Ambient shower inlet grate plain / silver

#### Specification

- Modern construction and stylish design in different sizes: 600, 700, 800, 900, 1000mm
- Wide sealing collar (30mm) ensuring tight jointing to the floor construction
- Adjustable height and fixable legs for integration in every kind of floor construction
- Easy installation due to product completeness and compatibility to wastewater installation system (dimension of waste pipes)

#### Application

- Housing sewage systems

#### Certification

- Technical assessment acc EN 1253

## Uponor Aqua Ambient shower inlet grate plain / silver 700mm

1136428

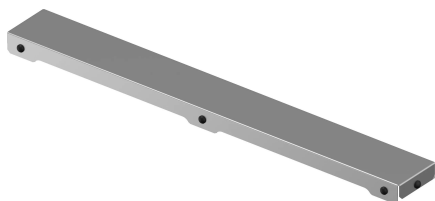

### Technical documents

Download documents here 

#### Uponor UK

Blackmor Lane The Pavilion  
WD18 8GA, Watford  
UK

T +44 (0)1923 927000  
E [enquiries.uk@uponor.com](mailto:enquiries.uk@uponor.com)

[www.uponor.com/en-gb](http://www.uponor.com/en-gb)