

## GF Silenta Premium double branch radius corner 87,5° 90-90mm

**1146356**

- Light Grey, PP-material with inorganic filler
- According to BS EN 1451

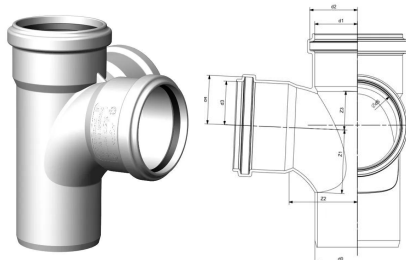

### About GF Silenta Premium double branch radius corner 87,5°

#### Specification

- Manufactured with the latest generation of multilayer (three different layers) polypropylene technology
- System according to the requirements of BS EN 1451
- Application are B to BS EN 1451
- 12 db(A) at 4l/s - tested to BS EN 14366
- Fire class D - s2, d2 to BS EN 13501-1
- Pipe diameters from 58 mm to 200 mm
- Wide range of fittings to give complete design freedom
- For use with GF Silent Clamp range

#### Application

Applications:

Silenta Premium is suitable for various wastewater types and areas of use, including:

- High end residential, multi-family residential, hotels, healthcare, restaurants, etc
- Sustainable/green buildings
- Industrial facilities (short- and long-term use)
- Domestic sewage and rainwater
- Wastewater from kitchens, bathrooms, laundry rooms, toilets, and similar spaces

Commercial/Industrial Wastewater:

- For untreated wastewater containing harmful substances
- Guidance relating to chemical resistance of Polypropylene can be sought from ISO/TR 10358
- For full system chemical compatibility please contact GF
- Required details for assessment:
  - Substance composition
  - Concentration and pH values
  - Quantities and flow rates
  - Wastewater temperature

## GF Silenta Premium double branch radius corner 87,5° 90-90mm

1146356

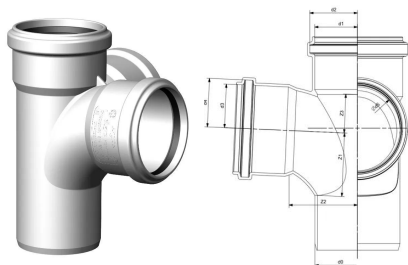

### Status

Item Available From date 2026-03-01

### Product code

Item no EAN 8698652155029

Item no GF 4501209030721

Item no GTIN 08698652155029

Item no VVS 186851014

### Dimensions

Item Unit Height 235

Item Unit Length 187

Item Unit Weight 0,838

Item Unit Width 187

Item\_UOM pce

### Packaging

Packaging GTIN PL1 06414900598903

Packaging GTIN PL2 06414900265515

Packaging GTIN PL3 06414900050425

Packaging GTIN PL4 06414900214872

Packaging Height PL1 235

Packaging Height PL2 187

Packaging Height PL3 360

Packaging Height PL4 1200

Packaging Length PL1 187

Packaging Length PL2 374

Packaging Length PL3 590

Packaging Length PL4 1200

Packaging Quantity PL1 1

Packaging Quantity PL2 2

Packaging Quantity PL3	12
Packaging Quantity PL4	144
Packaging Type PL1	Piece
Packaging Type PL2	Bag
Packaging Type PL3	Box
Packaging Type PL4	Pallet
Packaging Volume PL1	0,008217715
Packaging Volume PL2	0,013078406
Packaging Volume PL3	0,082836
Packaging Volume PL4	1,152
Packaging Weight PL1	0,838
Packaging Weight PL2	1,676
Packaging Weight PL3	10,056
Packaging Weight PL4	145,672
Packaging Width PL1	187
Packaging Width PL2	187
Packaging Width PL3	390
Packaging Width PL4	800

## Measurements

Z Measurement ALPHA	87,5
Z Measurement d	45
Z Measurement d1	45,25
Z Measurement d2	50,75
Z Measurement d3	45,25
Z Measurement d3	45,25
Z Measurement d4	50,75
Z Measurement d6	50,75
Z Measurement e	4,7
z1	64,6
Z2	75,1
Z3	42,2

## Technical documents

Download documents here 

WD18 8GA, Watford  
UK

T +44 (0)1923 927000  
E enquiries.uk@uponor.com

[www.uponor.com/en-gb](http://www.uponor.com/en-gb)