

GF Silenta Premium double branch 45° 110-110mm

1146384

- Light Grey, PP-material with inorganic filler
- According to BS EN 1451

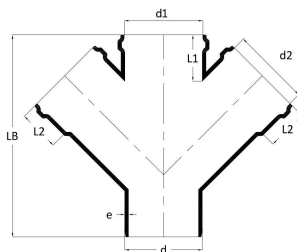

About GF Silenta Premium double branch 45°

Specification

- Manufactured with the latest generation of multilayer (three different layers) polypropylene technology
- System according to the requirements of BS EN 1451
- Application are B to BS EN 1451
- 12 db(A) at 4l/s - tested to BS EN 14366
- Fire class D - s2, d2 to BS EN 13501-1
- Pipe diameters from 58 mm to 200 mm
- Wide range of fittings to give complete design freedom
- For use with GF Silent Clamp range

Application

Applications:

Silenta Premium is suitable for various wastewater types and areas of use, including:

- High end residential, multi-family residential, hotels, healthcare, restaurants, etc
- Sustainable/green buildings
- Industrial facilities (short- and long-term use)
- Domestic sewage and rainwater
- Wastewater from kitchens, bathrooms, laundry rooms, toilets, and similar spaces

Commercial/Industrial Wastewater:

- For untreated wastewater containing harmful substances
- Guidance relating to chemical resistance of Polypropylene can be sought from ISO/TR 10358
- For full system chemical compatibility please contact GF
- Required details for assessment:
 - Substance composition
 - Concentration and pH values
 - Quantities and flow rates
 - Wastewater temperature

GF Silenta Premium double branch 45° 110-110mm

1146384

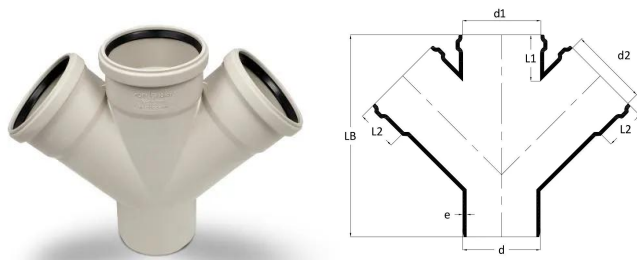

Status

Item Available From date

2026-03-01

Product code

Item no EAN	8698652133836
Item no GF	4501211031021
Item no GTIN	08698652133836
Item no VVS	186848016

Dimensions

Item Unit Height	292
Item Unit Length	135
Item Unit Weight	1,564
Item Unit Width	378
Item_UOM	pce

Measurements

Length (l2)	63
Z Measurement d2	110
Z Measurement e	5,3

Packaging

Packaging GTIN PL1	06414900601719
Packaging GTIN PL2	06414900050708
Packaging GTIN PL4	06414900215152
Packaging Height PL1	292
Packaging Height PL2	360
Packaging Height PL4	1200
Packaging Length PL1	135
Packaging Length PL2	590
Packaging Length PL4	1200
Packaging Quantity PL1	1

Packaging Quantity PL2	6
Packaging Quantity PL4	72
Packaging Type PL1	Piece
Packaging Type PL2	Medium_Box
Packaging Type PL4	Pallet
Packaging Volume PL1	0,01490076
Packaging Volume PL2	0,082836
Packaging Volume PL4	1,152
Packaging Weight PL1	1,564
Packaging Weight PL2	9,384
Packaging Weight PL4	137,608
Packaging Width PL1	378
Packaging Width PL2	390
Packaging Width PL4	800

Technical documents

Download documents here 

Uponor UK

Blackmor Lane The Pavillion
 WD18 8GA, Watford
 UK

T +44 (0)1923 381212
 E
customerservice.uk.bfs@georgfischer.com