

GF Silenta Premium double branch corner 87,5° 110-110mm

1146388

- Light Grey, PP-material with inorganic filler
- According to BS EN 1451

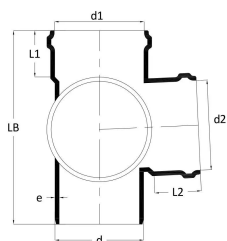

About GF Silenta Premium double branch corner 87,5°

Specification

- Manufactured with the latest generation of multilayer (three different layers) polypropylene technology
- System according to the requirements of BS EN 1451
- Application are B to BS EN 1451
- 12 db(A) at 4l/s - tested to BS EN 14366
- Fire class D - s2, d2 to BS EN 13501-1
- Pipe diameters from 58 mm to 200 mm
- Wide range of fittings to give complete design freedom
- For use with GF Silent Clamp range

Application

Applications:

Silenta Premium is suitable for various wastewater types and areas of use, including:

- High end residential, multi-family residential, hotels, healthcare, restaurants, etc
- Sustainable/green buildings
- Industrial facilities (short- and long-term use)
- Domestic sewage and rainwater
- Wastewater from kitchens, bathrooms, laundry rooms, toilets, and similar spaces

Commercial/Industrial Wastewater:

- For untreated wastewater containing harmful substances
- Guidance relating to chemical resistance of Polypropylene can be sought from ISO/TR 10358
- For full system chemical compatibility please contact GF
- Required details for assessment:
 - Substance composition
 - Concentration and pH values
 - Quantities and flow rates
 - Wastewater temperature

GF Silenta Premium double branch corner 87,5° 110-110mm

1146388

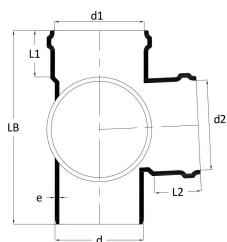

Status

Item Available From date

2026-03-01

Product code

Item no EAN 8698652133850

Item no GF 4501211031521

Item no GTIN 08698652133850

Item no VVS 186851016

Dimensions

Item Unit Height 241

Item Unit Length 201

Item Unit Weight 1,46

Item Unit Width 201

Item_UOM pce

Packaging

Packaging GTIN PL1 06414900602075

Packaging GTIN PL2 06414900050746

Packaging GTIN PL4 06414900215190

Packaging Height PL1 241

Packaging Height PL2 360

Packaging Height PL4 1200

Packaging Length PL1 201

Packaging Length PL2 590

Packaging Length PL4 1200

Packaging Quantity PL1 1

Packaging Quantity PL2 8

Packaging Quantity PL4 96

Packaging Type PL1 Piece

Packaging Type PL2 Medium_Box

Packaging Type PL4	Pallet
Packaging Volume PL1	0,009736641
Packaging Volume PL2	0,082836
Packaging Volume PL4	1,152
Packaging Weight PL1	1,46
Packaging Weight PL2	11,68
Packaging Weight PL4	165,16
Packaging Width PL1	201
Packaging Width PL2	390
Packaging Width PL4	800

Measurements

Z Measurement e	5,3
-----------------	-----

Technical documents

[Download documents here](#)

Uponor UK

Blackmor Lane The Pavillion
WD18 8GA, Watford
UK

T +44 (0)1923 381212
E
customerservice.uk.bfs@georgfi
scher.com