

GF Silenta Premium double branch 45° 135-110mm

1146401

- Light Grey, PP-material with inorganic filler
- According to BS EN 1451

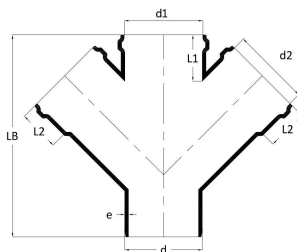

About GF Silenta Premium double branch 45°

Specification

- Manufactured with the latest generation of multilayer (three different layers) polypropylene technology
- System according to the requirements of BS EN 1451
- Application are B to BS EN 1451
- 12 db(A) at 4l/s - tested to BS EN 14366
- Fire class D - s2, d2 to BS EN 13501-1
- Pipe diameters from 58 mm to 200 mm
- Wide range of fittings to give complete design freedom
- For use with GF Silent Clamp range

Application

Applications:

Silenta Premium is suitable for various wastewater types and areas of use, including:

- High end residential, multi-family residential, hotels, healthcare, restaurants, etc
- Sustainable/green buildings
- Industrial facilities (short- and long-term use)
- Domestic sewage and rainwater
- Wastewater from kitchens, bathrooms, laundry rooms, toilets, and similar spaces

Commercial/Industrial Wastewater:

- For untreated wastewater containing harmful substances
- Guidance relating to chemical resistance of Polypropylene can be sought from ISO/TR 10358
- For full system chemical compatibility please contact GF
- Required details for assessment:
 - Substance composition
 - Concentration and pH values
 - Quantities and flow rates
 - Wastewater temperature

GF Silenta Premium double branch 45° 135-110mm

1146401

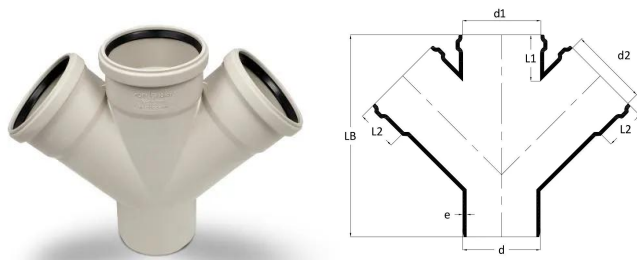

Status

Item Available From date

2026-03-01

Product code

Item no EAN 8698652133928

Item no GF 4501213531021

Item no GTIN 08698652133928

Item no VVS 186848196

Dimensions

Item Unit Height 306

Item Unit Length 160

Item Unit Weight 2,317

Item Unit Width 403

Item_UOM pce

Measurements

Length (l2) 63

Z Measurement d2 110

Z Measurement e 5,3

Packaging

Packaging GTIN PL1 06414900554091

Packaging GTIN PL2 06414900050876

Packaging GTIN PL4 06414900215329

Packaging Height PL1 306

Packaging Height PL2 360

Packaging Height PL4 1200

Packaging Length PL1 160

Packaging Length PL2 390

Packaging Length PL4 1200

Packaging Quantity PL1 1

Packaging Quantity PL2	2
Packaging Quantity PL4	48
Packaging Type PL1	Piece
Packaging Type PL2	Medium_Box
Packaging Type PL4	Pallet
Packaging Volume PL1	0,01973088
Packaging Volume PL2	0,040716
Packaging Volume PL4	1,152
Packaging Weight PL1	2,317
Packaging Weight PL2	4,634
Packaging Weight PL4	136,216
Packaging Width PL1	403
Packaging Width PL2	290
Packaging Width PL4	800

Technical documents

Download documents here 

Uponor UK

Blackmor Lane The Pavillion
 WD18 8GA, Watford
 UK

T +44 (0)1923 381212

E
customerservice.uk.bfs@georgfischer.com