

## GF Silenta Premium double branch 45° 160-110mm

**1146411**

- Light Grey, PP-material with inorganic filler
- According to BS EN 1451

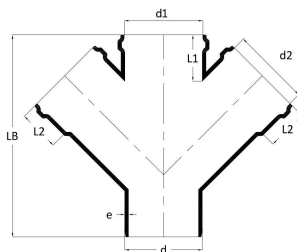

### About GF Silenta Premium double branch 45°

#### Specification

- Manufactured with the latest generation of multilayer (three different layers) polypropylene technology
- System according to the requirements of BS EN 1451
- Application are B to BS EN 1451
- 12 db(A) at 4l/s - tested to BS EN 14366
- Fire class D - s2, d2 to BS EN 13501-1
- Pipe diameters from 58 mm to 200 mm
- Wide range of fittings to give complete design freedom
- For use with GF Silent Clamp range

#### Application

Applications:

Silenta Premium is suitable for various wastewater types and areas of use, including:

- High end residential, multi-family residential, hotels, healthcare, restaurants, etc
- Sustainable/green buildings
- Industrial facilities (short- and long-term use)
- Domestic sewage and rainwater
- Wastewater from kitchens, bathrooms, laundry rooms, toilets, and similar spaces

Commercial/Industrial Wastewater:

- For untreated wastewater containing harmful substances
- Guidance relating to chemical resistance of Polypropylene can be sought from ISO/TR 10358
- For full system chemical compatibility please contact GF
- Required details for assessment:
  - Substance composition
  - Concentration and pH values
  - Quantities and flow rates
  - Wastewater temperature

## GF Silenta Premium double branch 45° 160-110mm

1146411

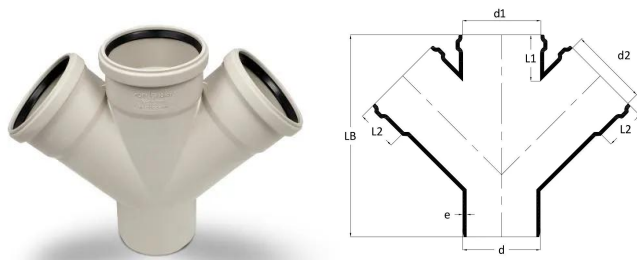

### Status

Item Available From date

2026-03-01

### Product code

Item no EAN 8698652133966

Item no GF 4501216030521

Item no GTIN 08698652133966

Item no VVS 186848197

### Dimensions

Item Unit Height 320

Item Unit Length 188

Item Unit Weight 2,402

Item Unit Width 428

Item\_UOM pce

### Measurements

Length (l2) 63

Z Measurement d2 110

Z Measurement e 5,3

### Packaging

Packaging GTIN PL1 06414900554725

Packaging GTIN PL2 06414900050975

Packaging GTIN PL4 06414900215428

Packaging Height PL1 320

Packaging Height PL2 360

Packaging Height PL4 1200

Packaging Length PL1 188

Packaging Length PL2 590

Packaging Length PL4 1200

Packaging Quantity PL1 1

Packaging Quantity PL2	3
Packaging Quantity PL4	36
Packaging Type PL1	Piece
Packaging Type PL2	Medium_Box
Packaging Type PL4	Pallet
Packaging Volume PL1	0,02574848
Packaging Volume PL2	0,082836
Packaging Volume PL4	1,152
Packaging Weight PL1	2,402
Packaging Weight PL2	7,206
Packaging Weight PL4	111,472
Packaging Width PL1	428
Packaging Width PL2	390
Packaging Width PL4	800

## Technical documents

Download documents here 

### Uponor UK

Blackmor Lane The Pavillion  
 WD18 8GA, Watford  
 UK

T +44 (0)1923 381212

E  
[customerservice.uk.bfs@georgfischer.com](mailto:customerservice.uk.bfs@georgfischer.com)