

## GF HT-PP double branch 45° 50-50mm

**1150155**

- Grey, PP-material
- According to BS EN 1451

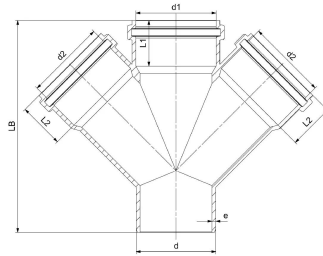

### About GF HT-PP double branch 45°

#### Specification

- Manufactured using chemical and temperature resistant Polypropylene
- System according to the requirements of BS EN 1451
- Application area B to BS EN 1451
- Fire class E to BS EN 13501-1
- Pipe diameters from 32 mm to 160 mm
- Wide range of fittings to give complete design freedom
- For use with GF standard Clamp fittings

#### Application

- Office buildings and conference halls
- Schools, libraries, hospitals, hotels, and residential buildings
- Sustainable and green buildings
- Industrial facilities for both short- and long-term applications
- Ideal for pre-fabricated buildings

## GF HT-PP double branch 45° 50-50mm

1150155

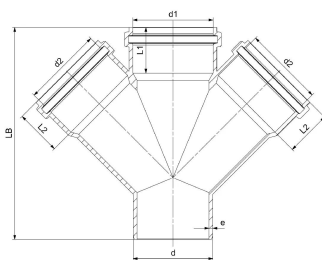

### Status

Item Available From date

2026-03-01

### Product code

Item no EAN	8698652042367
Item no GF	4901205012021
Item no GTIN	08698652042367
Item no VVS	186416050

### Dimensions

Item Unit Height	175
Item Unit Length	65
Item Unit Weight	0,118
Item Unit Width	195
Item_UOM	pce

### Measurements

Length (l2)	48,9
Wall thickness_s	16
Z Measurement b1	5
Z Measurement b2	5
Z Measurement d	50
Z Measurement d1	50
Z Measurement d2	59,6
Z Measurement d3	50,5
Z Measurement d3	50,5
Z Measurement d4	59,6
Z Measurement d5	50,5
Z Measurement d6	59,6
Z Measurement e	1,8
Z Measurement L1	48,9

z1	71,2
Z2	50,6
<b>Packaging</b>	
Packaging GTIN PL1	06414900553445
Packaging GTIN PL2	06414900231190
Packaging GTIN PL4	06414900104517
Packaging Height PL1	175
Packaging Height PL2	400
Packaging Height PL4	1200
Packaging Length PL1	65
Packaging Length PL2	800
Packaging Length PL4	1200
Packaging Quantity PL1	1
Packaging Quantity PL2	100
Packaging Quantity PL4	600
Packaging Type PL1	Piece
Packaging Type PL2	Medium_Box
Packaging Type PL4	Pallet
Packaging Volume PL1	0,002218125
Packaging Volume PL2	0,192
Packaging Volume PL4	1,152
Packaging Weight PL1	0,118
Packaging Weight PL2	11,8
Packaging Weight PL4	95,8
Packaging Width PL1	195
Packaging Width PL2	600
Packaging Width PL4	800

## Technical documents

Download documents here 

### Uponor UK

Blackmor Lane The Pavillion  
WD18 8GA, Watford  
UK

T +44 (0)1923 381212

E

customerservice.uk.bfs@georgfi  
scher.com