

## GF HT-PP double branch 45° 110-110mm

**1150168**

- Grey, PP-material
- According to BS EN 1451

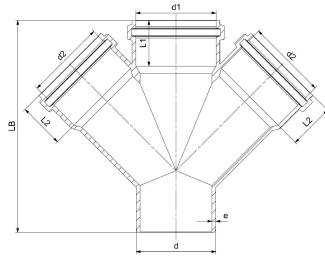

### About GF HT-PP double branch 45°

#### Specification

- Manufactured using chemical and temperature resistant Polypropylene
- System according to the requirements of BS EN 1451
- Application area B to BS EN 1451
- Fire class E to BS EN 13501-1
- Pipe diameters from 32 mm to 160 mm
- Wide range of fittings to give complete design freedom
- For use with GF standard Clamp fittings

#### Application

- Office buildings and conference halls
- Schools, libraries, hospitals, hotels, and residential buildings
- Sustainable and green buildings
- Industrial facilities for both short- and long-term applications
- Ideal for pre-fabricated buildings

## GF HT-PP double branch 45° 110-110mm

1150168



### Status

Item Available From date

2026-03-01

### Product code

Item no EAN

8698652042381

Item no GF

4901211014021

Item no GTIN

08698652042381

Item no VVS

186416110

### Dimensions

Item Unit Height

292

Item Unit Length

135

Item Unit Weight

0,84

Item Unit Width

378

Item\_UOM

pce

### Measurements

Length (l2)

64,4

Wall thickness\_s

16

Z Measurement b1

6

Z Measurement b2

6

Z Measurement d

110

Z Measurement d1

110

Z Measurement d2

121,2

Z Measurement d3

110,5

Z Measurement d3

110,5

Z Measurement d4

121,2

Z Measurement d5

110,5

Z Measurement d6

121,2

Z Measurement e

3,4

Z Measurement L1

64,4

z1	156,5
Z2	111
<b>Packaging</b>	
Packaging GTIN PL1	06414900554084
Packaging GTIN PL2	06414900231329
Packaging GTIN PL4	06414900104791
Packaging Height PL1	292
Packaging Height PL2	400
Packaging Height PL4	1200
Packaging Length PL1	135
Packaging Length PL2	800
Packaging Length PL4	1200
Packaging Quantity PL1	1
Packaging Quantity PL2	16
Packaging Quantity PL4	96
Packaging Type PL1	Piece
Packaging Type PL2	Medium_Box
Packaging Type PL4	Pallet
Packaging Volume PL1	0,01490076
Packaging Volume PL2	0,192
Packaging Volume PL4	1,44
Packaging Weight PL1	0,84
Packaging Weight PL2	13,44
Packaging Weight PL4	105,64
Packaging Width PL1	378
Packaging Width PL2	600
Packaging Width PL4	1000

## Technical documents

Download documents here 

### Uponor UK

Blackmor Lane The Pavillion  
WD18 8GA, Watford  
UK

T +44 (0)1923 381212

E  
customerservice.uk.bfs@georgfi  
scher.com