

GF HT-PP sleeve socket 50mm

1150195

- Grey, PP-material
- According to BS EN 1451

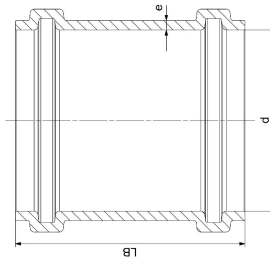

About GF HT-PP sleeve socket

Specification

- Manufactured using chemical and temperature resistant Polypropylene
- System according to the requirements of BS EN 1451
- Application area B to BS EN 1451
- Fire class E to BS EN 13501-1
- Pipe diameters from 32 mm to 160 mm
- Wide range of fittings to give complete design freedom
- For use with GF standard Clamp fittings

Application

- Office buildings and conference halls
- Schools, libraries, hospitals, hotels, and residential buildings
- Sustainable and green buildings
- Industrial facilities for both short- and long-term applications
- Ideal for pre-fabricated buildings

GF HT-PP sleeve socket 50mm

1150195



Status

Item Available From date

2026-03-01

Product code

Item no EAN	8698652094410
Item no GF	4901505031721
Item no GTIN	08698652094410
Item no VVS	186543050

Dimensions

Item Unit Height	92
Item Unit Length	64
Item Unit Weight	0,0649
Item Unit Width	64
Item_UOM	pce

Packaging

Packaging GTIN PL1	06414900555340
Packaging GTIN PL2	06414900231596
Packaging GTIN PL4	06414900105347
Packaging Height PL1	92
Packaging Height PL2	400
Packaging Height PL4	1200
Packaging Length PL1	64
Packaging Length PL2	800
Packaging Length PL4	1200
Packaging Quantity PL1	1
Packaging Quantity PL2	400
Packaging Quantity PL4	2400
Packaging Type PL1	Piece
Packaging Type PL2	Medium_Box

Packaging Type PL4	Pallet
Packaging Volume PL1	0,000376832
Packaging Volume PL2	0,192
Packaging Volume PL4	1,44
Packaging Weight PL1	0,0649
Packaging Weight PL2	25,96
Packaging Weight PL4	180,76
Packaging Width PL1	64
Packaging Width PL2	600
Packaging Width PL4	1000

Measurements

Wall thickness_s	16
Z Measurement d	50
Z Measurement d1	50,5
Z Measurement d2	59,6
Z Measurement e	1,8

Technical documents

Download documents here

Uponor UK

Blackmor Lane The Pavillion
 WD18 8GA, Watford
 UK

T +44 (0)1923 381212
 E
 customerservice.uk.bfs@georgfi
 scher.com