

GF HT-PP sleeve socket 160mm

1150202

- Grey, PP-material
- According to BS EN 1451

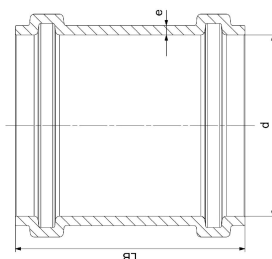

About GF HT-PP sleeve socket

Specification

- Manufactured using chemical and temperature resistant Polypropylene
- System according to the requirements of BS EN 1451
- Application area B to BS EN 1451
- Fire class E to BS EN 13501-1
- Pipe diameters from 32 mm to 160 mm
- Wide range of fittings to give complete design freedom
- For use with GF standard Clamp fittings

Application

- Office buildings and conference halls
- Schools, libraries, hospitals, hotels, and residential buildings
- Sustainable and green buildings
- Industrial facilities for both short- and long-term applications
- Ideal for pre-fabricated buildings

GF HT-PP sleeve socket 160mm

1150202



Status

Item Available From date

2026-03-01

Product code

Item no EAN	8698652092126
Item no GF	4901516032021
Item no GTIN	08698652092126
Item no VVS	186543160

Dimensions

Item Unit Height	140
Item Unit Length	188
Item Unit Weight	0,508
Item Unit Width	188
Item_UOM	pce

Packaging

Packaging GTIN PL1	06414900554947
Packaging GTIN PL2	06414900231664
Packaging GTIN PL4	06414900105491
Packaging Height PL1	140
Packaging Height PL2	400
Packaging Height PL4	1200
Packaging Length PL1	188
Packaging Length PL2	800
Packaging Length PL4	1200
Packaging Quantity PL1	1
Packaging Quantity PL2	30
Packaging Quantity PL4	180
Packaging Type PL1	Piece
Packaging Type PL2	Medium_Box

Packaging Type PL4	Pallet
Packaging Volume PL1	0,00494816
Packaging Volume PL2	0,192
Packaging Volume PL4	1,44
Packaging Weight PL1	0,508
Packaging Weight PL2	15,24
Packaging Weight PL4	116,44
Packaging Width PL1	188
Packaging Width PL2	600
Packaging Width PL4	1000

Measurements

Wall thickness_s	16
Z Measurement d	160
Z Measurement d1	160,6
Z Measurement d2	175,2
Z Measurement e	5,3

Technical documents

Download documents here 

Uponor UK

Blackmor Lane The Pavillion
 WD18 8GA, Watford
 UK

T +44 (0)1923 381212
 E
 customerservice.uk.bfs@georgfi
 scher.com