

GF iFIT adapter 25

1151111

- Material: PPSU, PA
- PN 16 at 20°C

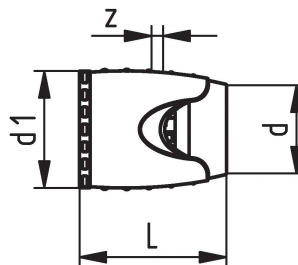
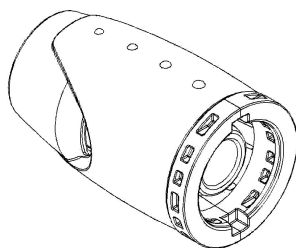

About GF iFIT adapter

Specification

- The iFIT system is subject to constant inspection by internal and external bodies.
- These inspections range from quality assurance during production to ISO certification for environmental and process safety. The iFIT system meets the requirements for the most important applications in the building technology and is subject to constant monitoring by the licensing offices for drinking water and heating installations on land and sea.

Application

- Application area Cold and hot water, HVAC, greywater
-
- Installation Surface and flush-mounted pipes, pipe-in-pipe technology

Certification

- SVGW
- DVGW
- ÖVGW

GF iFIT adapter 25

1151111

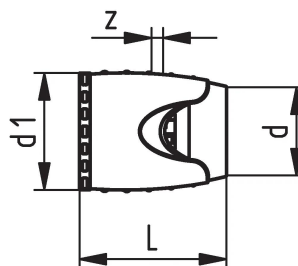
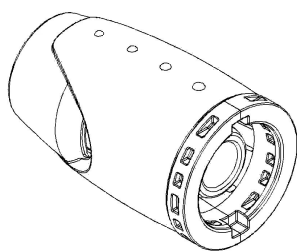

Measurements

Inner_diameter_di	45
LENGTH_L	62
Z	8

Product code

Item no EAN	7611205885427
Item no GF	762101034
Item no GTIN	07611205885427
Item no LVI	1749398
Item no RSK	1878642

Dimensions

Item Unit Height	45
Item Unit Length	60
Item Unit Weight	0,07
Item Unit Width	40
Item_UOM	pce

Packaging

Packaging GTIN PL1	07611205904890
Packaging GTIN PL2	07611205904883
Packaging GTIN PL4	06414900118767
Packaging Height PL1	50
Packaging Height PL2	225
Packaging Height PL4	1200
Packaging Length PL1	165
Packaging Length PL2	410
Packaging Length PL4	1200
Packaging Quantity PL1	5
Packaging Quantity PL2	50

Packaging Quantity PL4	2250
Packaging Type PL1	Plastic_Bag
Packaging Type PL2	Medium_Box
Packaging Type PL4	Pallet
Packaging Volume PL1	0,001155
Packaging Volume PL2	0,02444625
Packaging Volume PL4	1,152
Packaging Weight PL1	0,357817343792857
Packaging Weight PL2	3,88943465302637
Packaging Weight PL4	200,024559386187
Packaging Width PL1	140
Packaging Width PL2	265
Packaging Width PL4	800

Technical documents

Download documents here 

Uponor UK

Blackmor Lane The Pavilion
WD18 8GA, Watford
UK

T +44 (0)1923 927000
E enquiries.uk@uponor.com

www.uponor.com/en-gb