

GF iFIT adapter 32

1151112

- Material: PPSU, PA
- PN 16 at 20°C

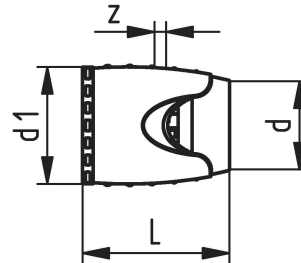
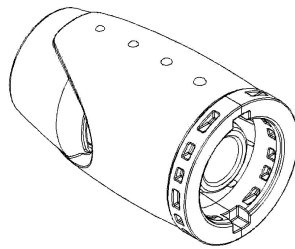

About GF iFIT adapter

Specification

- The iFIT system is subject to constant inspection by internal and external bodies.
- These inspections range from quality assurance during production to ISO certification for environmental and process safety. The iFIT system meets the requirements for the most important applications in the building technology and is subject to constant monitoring
- by the licensing offices for drinking water and heating installations on land and sea.

Application

- Application area Cold and hot water, HVAC, greywater
-
- Installation Surface and flush-mounted pipes, pipe-in-pipe technology

Certification

- SVGW
- DVGW
- ÖVGW

GF iFIT adapter 32

1151112

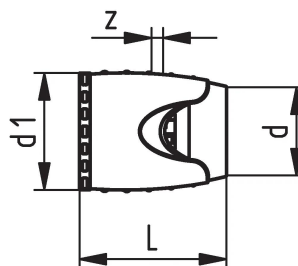
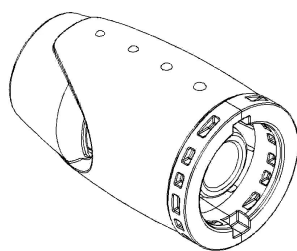

Measurements

Inner_diameter_di	52
LENGTH_L	63
Z	8

Product code

Item no EAN	7611205885434
Item no GF	762101035
Item no GTIN	07611205885434
Item no LVI	1749399
Item no RSK	1878643

Dimensions

Item Unit Height	51
Item Unit Length	67
Item Unit Weight	0,085
Item Unit Width	51
Item_UOM	pce

Packaging

Packaging GTIN PL1	07611205909420
Packaging GTIN PL2	06414900196185
Packaging GTIN PL4	06414900196192
Packaging Height PL1	67
Packaging Height PL2	225
Packaging Height PL4	1200
Packaging Length PL1	184
Packaging Length PL2	410
Packaging Length PL4	1200
Packaging Quantity PL1	5
Packaging Quantity PL2	50

Packaging Quantity PL4	2250
Packaging Type PL1	Plastic_Bag
Packaging Type PL2	Medium_Box
Packaging Type PL4	Pallet
Packaging Volume PL1	0,00178756
Packaging Volume PL2	0,02444625
Packaging Volume PL4	1,152
Packaging Weight PL1	0,442
Packaging Weight PL2	4,697
Packaging Weight PL4	234
Packaging Width PL1	145
Packaging Width PL2	265
Packaging Width PL4	800

Technical documents

[Download documents here](#)

Uponor UK

Blackmor Lane The Pavilion
WD18 8GA, Watford
UK

T +44 (0)1923 927000
E enquiries.uk@uponor.com

www.uponor.com/en-gb