

GF iFIT elbow 90deg 16/20

1151117

- Material: PPSU
- PN 16 at 20°C

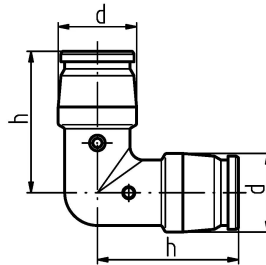
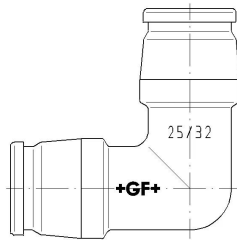

About GF iFIT elbow 90deg

Specification

- The iFIT system is subject to constant inspection by internal and external bodies.
- These inspections range from quality assurance during production to ISO certification for environmental and process safety. The iFIT system meets the requirements for the most important applications in the building technology and is subject to constant monitoring
- by the licensing offices for drinking water and heating installations on land and sea.

Application

- Application area Cold and hot water, HVAC, greywater
-
- Installation Surface and flush-mounted pipes, pipe-in-pipe technology

Certification

- SVGW
- DVGW
- ÖVGW

GF iFIT elbow 90deg 16/20

1151117

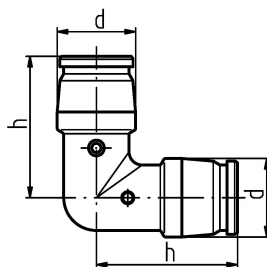

Product code

Item no EAN	7611205885694
Item no GF	762101046
Item no GTIN	07611205885694
Item no LVI	1749401
Item no RSK	1878661

Dimensions

Item Unit Height	46
Item Unit Length	46
Item Unit Weight	0,013
Item Unit Width	20
Item_UOM	pce

Packaging

Packaging GTIN PL1	07611205905019
Packaging GTIN PL2	07611205908843
Packaging GTIN PL4	06414900118736
Packaging Height PL1	50
Packaging Height PL2	225
Packaging Height PL4	100
Packaging Length PL1	160
Packaging Length PL2	410
Packaging Length PL4	1200
Packaging Quantity PL1	10
Packaging Quantity PL2	200
Packaging Quantity PL4	9000
Packaging Type PL1	Plastic_Bag
Packaging Type PL2	Medium_Box
Packaging Type PL4	Pallet

Packaging Volume PL1	0,00072
Packaging Volume PL2	0,02444625
Packaging Volume PL4	0,096
Packaging Weight PL1	0,14
Packaging Weight PL2	2,75
Packaging Weight PL4	140
Packaging Width PL1	90
Packaging Width PL2	265
Packaging Width PL4	800

Measurements

Z Measurement h	36
-----------------	----

Technical documents

[Download documents here](#)

Uponor UK

Blackmor Lane The Pavilion
WD18 8GA, Watford
UK

T +44 (0)1923 927000
E enquiries.uk@uponor.com

www.uponor.com/en-gb