

GF iFit tee equal 90deg 25/32

1151158

- Material: PPSU
- PN 16 at 20°C

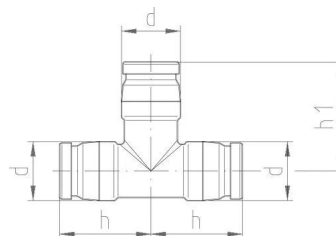
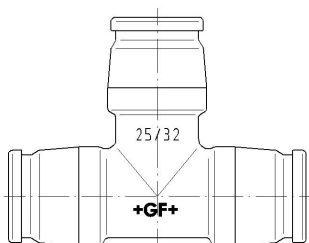

About GF iFIT tee equal 90deg

Specification

- The iFIT system is subject to constant inspection by internal and external bodies.
- These inspections range from quality assurance during production to ISO certification for environmental and process safety. The iFIT system meets the requirements for the most important applications in the building technology and is subject to constant monitoring
- by the licensing offices for drinking water and heating installations on land and sea.

Application

- Application area Cold and hot water, HVAC, greywater
-
- Installation Surface and flush-mounted pipes, pipe-in-pipe technology

Certification

- SVGW
- DVGW
- ÖVGW

GF iFit tee equal 90deg 25/32

1151158

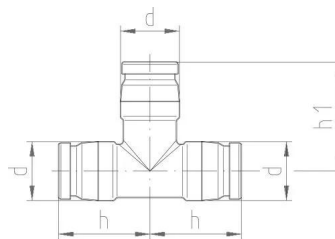
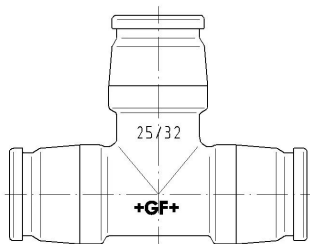

Product code

Item no EAN	7611205891992
Item no GF	762101181
Item no GTIN	07611205891992
Item no LVI	1749407
Item no RSK	1878670

Dimensions

Item Unit Height	28
Item Unit Length	91
Item Unit Weight	0,053
Item Unit Width	69
Item_UOM	pce

Packaging

Packaging GTIN PL1	6414900547789
Packaging GTIN PL3	7611205908775
Packaging GTIN PL4	6414900118705
Packaging Height PL1	150
Packaging Height PL3	225
Packaging Height PL4	800
Packaging Length PL1	100
Packaging Length PL3	410
Packaging Length PL4	1200
Packaging Quantity PL1	5
Packaging Quantity PL3	60
Packaging Quantity PL4	2760
Packaging Type PL1	Plastic_Bag
Packaging Type PL3	Box
Packaging Type PL4	Pallet

Packaging Volume PL1	0,00105
Packaging Volume PL3	0,02444625
Packaging Volume PL4	0,768
Packaging Weight PL1	0,3
Packaging Weight PL3	3,7
Packaging Weight PL4	193
Packaging Width PL1	70
Packaging Width PL3	265
Packaging Width PL4	800
Measurements	
Z Measurement h	45
Z Measurement h1	54

Technical documents

[Download documents here](#) 

Uponor UK

Blackmor Lane The Pavilion
WD18 8GA, Watford
UK

T +44 (0)1923 927000
E enquiries.uk@uponor.com

www.uponor.com/en-gb