

## GF Instaflex backing flange d40

**1151923**

- Material: Casting, GFK coated
- Suitable for flange adaptor
- Tighten the screws with torque as indicated
- Requires standard screws, nuts, washers
- \* on request

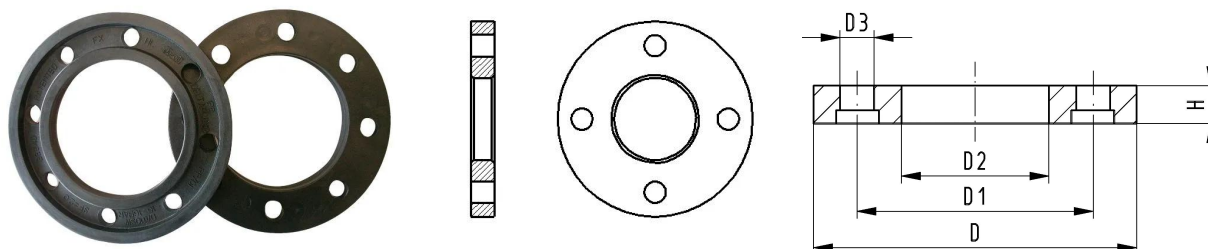

### About GF Instaflex backing flange

#### Specification

- The system is subject to constant inspection by internal and external bodies.
- These inspections range from quality assurance during production to ISO certification
- for environmental and process safety. The INSTAFLEX system meets all the essential
- requirements for building technology applications and is subject to constant monitoring by the
- licensing offices for drinking water, heating and compressed air installations on land and sea.

#### Application

Instaflex offers complete solutions for single-family homes, multi-family residential buildings, healthcare, education, industrial, or commercial building

##### Application areas

- hot & cold water, compressed air, cooling systems
- Surface and flush-mounted pipelines

#### Certification

- WRAS material approval (BS6920)

## GF Instaflex backing flange d40

1151923



### Product code

Item no EAN	7611205889968
Item no GF	761065273
Item no GTIN	07611205889968
Item no RSK	1874716

### Dimensions

Item Unit Height	18
Item Unit Length	143
Item Unit Weight	0,551
Item Unit Width	140
Item_UOM	pce

### Packaging

Packaging GTIN PL1	06414900064040
Packaging Height PL1	51
Packaging Length PL1	144
Packaging Quantity PL1	2
Packaging Type PL1	Plastic_Bag
Packaging Volume PL1	0,001050192
Packaging Weight PL1	1,163
Packaging Width PL1	143

### Technical documents

[Download documents here](#)

Blackfriar Lane The Pavilion  
WD18 8GA, Watford  
UK

T +44 (0)1923 927000  
E [enquiries.uk@uponor.com](mailto:enquiries.uk@uponor.com)

[www.uponor.com/en-gb](http://www.uponor.com/en-gb)