

GF Instaflex pipe clamp d32

1152015

- For iFIT, INSTAFLEX, JRG Sanipex, JRG Sanipex MT

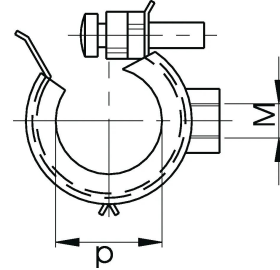
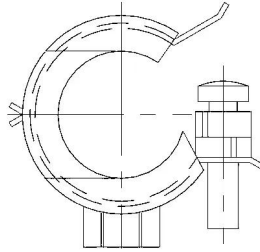

About GF Instaflex pipe clamp

Specification

- The system is subject to constant inspection by internal and external bodies.
- These inspections range from quality assurance during production to ISO certification
- for environmental and process safety. The INSTAFLEX system meets all the essential
- requirements for building technology applications and is subject to constant monitoring by the
- licensing offices for drinking water, heating and compressed air installations on land and sea.

Application

Instaflex offers complete solutions for single-family homes, multi-family residential buildings, healthcare, education, industrial, or commercial building

Application areas

- hot & cold water, compressed air, cooling systems
- Surface and flush-mounted pipelines

Certification

- WRAS material approval (BS6920)

GF Instaflex pipe clamp d32

1152015

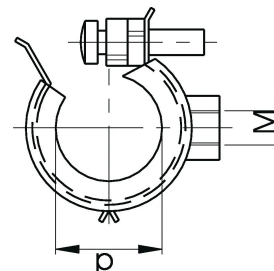

Status

Item Available From date

2025-10-01

Product code

Item no EAN 7611205822828

Item no GF 761066299

Item no GTIN 07611205822828

Item no LVI 2075363

Dimensions

Item Unit Height 28

Item Unit Length 65

Item Unit Weight 0,046

Item Unit Width 56

Item_UOM pce

Packaging

Packaging GTIN PL1 06414900064330

Packaging Height PL1 125

Packaging Length PL1 268

Packaging Quantity PL1 50

Packaging Type PL1 Base_Box

Packaging Volume PL1 0,006834

Packaging Weight PL1 3,153

Packaging Width PL1 204

Measurements

Z measurement m 8

Technical documents

Download documents here

www.uponor.com/en-gb