

## GF Instaflex reduction bush Socket Fusion d63-32

1152136

- Made of Polybuten

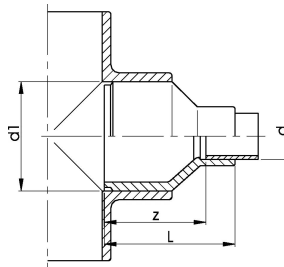
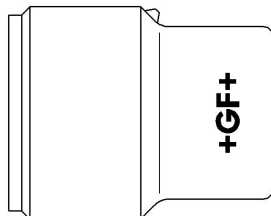

### About GF Instaflex reduction bush Socket Fusion

#### Specification

- The system is subject to constant inspection by internal and external bodies.
- These inspections range from quality assurance during production to ISO certification
- for environmental and process safety. The INSTAFLEX system meets all the essential
- requirements for building technology applications and is subject to constant monitoring by the
- licensing offices for drinking water, heating and compressed air installations on land and sea.

#### Application

Instaflex offers complete solutions for single-family homes, multi-family residential buildings, healthcare, education, industrial, or commercial building

##### Application areas

- hot & cold water, compressed air, cooling systems
- Surface and flush-mounted pipelines

#### Certification

- WRAS material approval (BS6920)

## GF Instaflex reduction bush Socket Fusion d63-32

1152136



### Measurements

Inner_diameter_di	63
LENGTH_L	58
Z	38

### Product code

Item no EAN	7611205819088
Item no GF	761066688
Item no GTIN	07611205819088
Item no RSK	1874757

### Dimensions

Item Unit Height	60
Item Unit Length	60
Item Unit Weight	0,066
Item Unit Width	60
Item_UOM	pce

### Packaging

Packaging GTIN PL1	06414900133043
Packaging GTIN PL4	06414900133050
Packaging Height PL1	62
Packaging Height PL4	800
Packaging Length PL1	70
Packaging Length PL4	1200
Packaging Quantity PL1	10
Packaging Quantity PL4	2700
Packaging Type PL1	Plastic_Bag
Packaging Type PL4	Pallet
Packaging Volume PL1	0,001302
Packaging Volume PL4	0,768

Packaging Weight PL1	0,67
Packaging Weight PL4	198,2
Packaging Width PL1	300
Packaging Width PL4	800

## Technical documents

Download documents here 

### Uponor UK

Blackmor Lane The Pavilion  
WD18 8GA, Watford  
UK

T +44 (0)1923 927000  
E [enquiries.uk@uponor.com](mailto:enquiries.uk@uponor.com)

[www.uponor.com/en-gb](http://www.uponor.com/en-gb)