

## GF Instaflex weld-in-saddle Socket Fusion 75-20

1152234

- \* on request

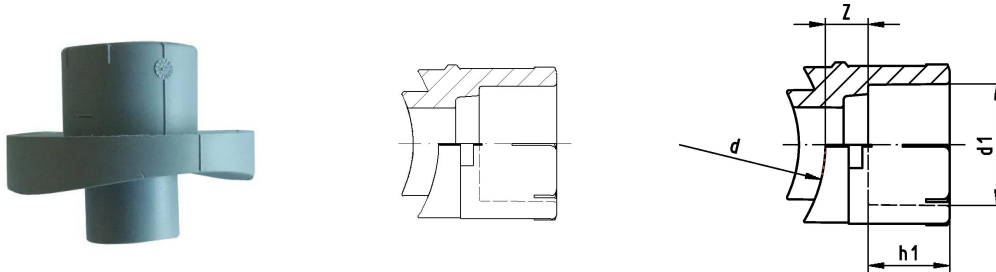

### About GF Instaflex weld-in-saddle Socket Fusion

#### Specification

- The system is subject to constant inspection by internal and external bodies.
- These inspections range from quality assurance during production to ISO certification
- for environmental and process safety. The INSTAFLEX system meets all the essential
- requirements for building technology applications and is subject to constant monitoring by the
- licensing offices for drinking water, heating and compressed air installations on land and sea.

#### Application

Instaflex offers complete solutions for single-family homes, multi-family residential buildings, healthcare, education, industrial, or commercial building

##### Application areas

- hot & cold water, compressed air, cooling systems
- Surface and flush-mounted pipelines

#### Certification

- WRAS material approval (BS6920)

## GF Instaflex weld-in-saddle Socket Fusion 75-20

1152234



### Product code

Item no EAN	7611205899387
Item no GF	761068009
Item no GTIN	07611205899387

### Dimensions

Item Unit Height	40
Item Unit Length	50
Item Unit Weight	0,014
Item Unit Width	50
Item_UOM	pce

### Packaging

Packaging GTIN PL1	06414900131766
Packaging GTIN PL4	06414900131773
Packaging Height PL1	120
Packaging Height PL4	1050
Packaging Length PL1	50
Packaging Length PL4	1200
Packaging Quantity PL1	5
Packaging Quantity PL4	7200
Packaging Type PL1	Plastic_Bag
Packaging Type PL4	Pallet
Packaging Volume PL1	0,0006
Packaging Volume PL4	1,008
Packaging Weight PL1	0,078
Packaging Weight PL4	132
Packaging Width PL1	100
Packaging Width PL4	800

### Measurements

Z Measurement d1	75 - 20
Z Measurement h1	15
Z	12

## Technical documents

Download documents here 

### Uponor UK

Blackmor Lane The Pavillion  
WD18 8GA, Watford  
UK

T +44 (0)1923 381212

E

customerservice.uk.bfs@georgfi  
scher.com