

GF Malleable Fittings long sweep bend 1 90° 1 1/2 B

1152734

- Long sweep bend 90°, ISO/EN G4
- Male / female

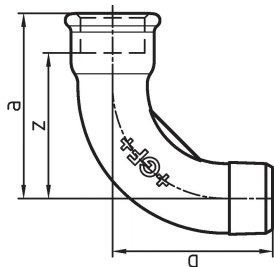

About GF Malleable Fittings long sweep bend 1 90°

Specification

- Unique Whiteheart ductile Cast Iron to EN-GJMW-400-5 to BS EN 1562, design symbol A
- Thread type BSP - R or Rp to BS EN 10226-1 / ISO 7-1
- Union or flat-nut thread types to BS EN 228-1
- Manufactured to BS EN 10242 (ISO 49)
- Cast Iron is fire class A1 to BS EN 13501-1 (CWFT) acc. to Commission Decision 96/603/EC (as amended)
- Natural Black or Galvanized (99.995 zinc)
- Coated with medical-grade oil for corrosion protection
- Suitable for systems covered by the Pressure Equipment Safety Regulation:2016
- Max. pressure 25 bar up to 120 degrees, between 120-300 degrees use interpolated values, Max. 20bar at 300 degrees
- Sizes from 1/4" to 4"

Application

- Heating - LTHW, MTHW and HTHW
- Steam
- Chilled water and cooling applications
- Compressed air
- Fuel gases
- Fuel oils
- Fire defence / sprinklers

GF Malleable Fittings long sweep bend 1 90° 1 1/2 B

1152734



Product code

Item no EAN	7611205300098
Item no GF	770001108
Item no GTIN	07611205300098
Item no LVI	0755006
Item no NOBB	60638814
Item no NRF	1366546
Item no RSK	1265073
Item no VVS	004001111

Dimensions

Item Unit Height	62
Item Unit Length	141
Item Unit Weight	0,894
Item Unit Width	136
Item_UOM	pce

Packaging

Packaging GTIN PL1	07611205100094
Packaging GTIN PL4	06414900242646
Packaging Height PL1	200
Packaging Height PL4	729
Packaging Length PL1	385
Packaging Length PL4	1200
Packaging Quantity PL1	20
Packaging Quantity PL4	540
Packaging Type PL1	Base_Box
Packaging Type PL4	Pallet
Packaging Volume PL1	0,019635
Packaging Volume PL4	0,69984

Packaging Weight PL1	18,3
Packaging Weight PL4	519,1
Packaging Width PL1	255
Packaging Width PL4	800

Measurements

Z	97
---	----

Technical documents

Download documents here 

Uponor UK

Blackmor Lane The Pavilion
WD18 8GA, Watford
UK

T +44 (0)1923 927000
E enquiries.uk@uponor.com

www.uponor.com/en-gb