

GF Malleable Fittings elbow 90 90° 1 1/4 G

1152981

- Elbow 90°, equal, ISO/EN A1
- Female / female

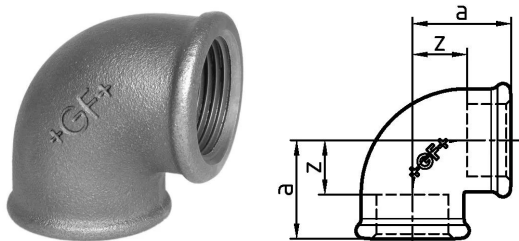

About GF Malleable Fittings elbow 90 90°

Specification

- Unique Whiteheart ductile Cast Iron to EN-GJMW-400-5 to BS EN 1562, design symbol A
- Thread type BSP - R or Rp to BS EN 10226-1 / ISO 7-1
- Union or flat-nut thread types to BS EN 228-1
- Manufactured to BS EN 10242 (ISO 49)
- Cast Iron is fire class A1 to BS EN 13501-1 (CWFT) acc. to Commission Decision 96/603/EC (as amended)
- Natural Black or Galvanized (99.995 zinc)
- Coated with medical-grade oil for corrosion protection
- Suitable for systems covered by the Pressure Equipment Safety Regulation:2016
- Max. pressure 25 bar up to 120 degrees, between 120-300 degrees use interpolated values, Max. 20bar at 300 degrees
- Sizes from 1/4" to 4"

Application

- Heating - LTHW, MTHW and HTHW
- Steam
- Chilled water and cooling applications
- Compressed air
- Fuel gases
- Fuel oils
- Fire defence / sprinklers

GF Malleable Fittings elbow 90 90° 1 1/4 G

1152981

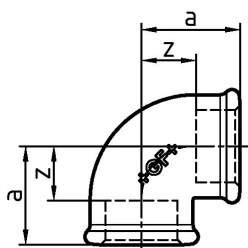

Product code

Item no EAN	7611205407353
Item no GF	770090207
Item no GTIN	07611205407353
Item no LVI	0855030
Item no NOBB	60638876
Item no NRF	1366608
Item no RSK	1270214
Item no VVS	004090410

Dimensions

Item Unit Height	55
Item Unit Length	73
Item Unit Weight	0,4682
Item Unit Width	73
Item_UOM	pce

Packaging

Packaging GTIN PL1	07611205207359
Packaging GTIN PL4	06414900187121
Packaging Height PL1	200
Packaging Height PL4	729
Packaging Length PL1	260
Packaging Length PL4	1200
Packaging Quantity PL1	20
Packaging Quantity PL4	1080
Packaging Type PL1	Base_Box
Packaging Type PL4	Pallet
Packaging Volume PL1	0,00988
Packaging Volume PL4	0,69984

Packaging Weight PL1	9,578
Packaging Weight PL4	525,656
Packaging Width PL1	190
Packaging Width PL4	800

Measurements

Z	26
---	----

Technical documents

Download documents here 

Uponor UK

Blackmor Lane The Pavilion
WD18 8GA, Watford
UK

T +44 (0)1923 927000
E enquiries.uk@uponor.com

www.uponor.com/en-gb