

GF Malleable Fittings 132 - twin elbow, black 3/4

1153557

- Twin elbow, equal, ISO/EN E2

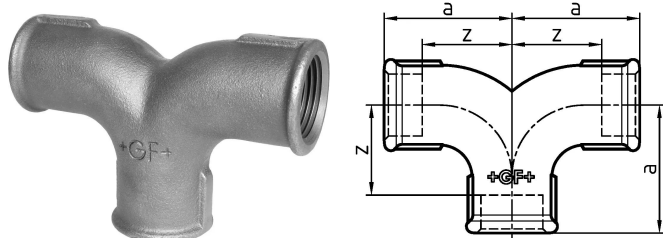

About GF Malleable Fittings 132 - twin elbow, black

Specification

- Unique Whiteheart ductile Cast Iron to EN-GJMW-400-5 to BS EN 1562, design symbol A
- Thread type BSP - R or Rp to BS EN 10226-1 / ISO 7-1
- Union or flat-nut thread types to BS EN 228-1
- Manufactured to BS EN 10242 (ISO 49)
- Cast Iron is fire class A1 to BS EN 13501-1 (CWFT) acc. to Commission Decision 96/603/EC (as amended)
- Natural Black or Galvanized (99.995 zinc)
- Coated with medical-grade oil for corrosion protection
- Suitable for systems covered by the Pressure Equipment Safety Regulation:2016
- Max. pressure 25 bar up to 120 degrees, between 120-300 degrees use interpolated values, Max. 20bar at 300 degrees
- Sizes from 1/4" to 4"

Application

- Heating - LTHW, MTHW and HTHW
- Steam
- Chilled water and cooling applications
- Compressed air
- Fuel gases
- Fuel oils
- Fire defence / sprinklers

GF Malleable Fittings 132 - twin elbow, black 3/4

1153557

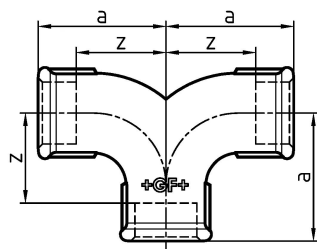

Product code

Item no EAN	7611205317225
Item no GF	770132105
Item no GTIN	07611205317225
Item no RSK	1290048
Item no VVS	004132106

Dimensions

Item Unit Height	38
Item Unit Length	100
Item Unit Weight	0,371
Item Unit Width	69
Item_UOM	pce

Packaging

Packaging GTIN PL1	07611205117221
Packaging GTIN PL4	06414900181228
Packaging Height PL1	200
Packaging Height PL4	729
Packaging Length PL1	260
Packaging Length PL4	1200
Packaging Quantity PL1	30
Packaging Quantity PL4	1620
Packaging Type PL1	Base_Box
Packaging Type PL4	Pallet
Packaging Volume PL1	0,00988
Packaging Volume PL4	0,69984
Packaging Weight PL1	11,353
Packaging Weight PL4	621,506
Packaging Width PL1	190

Packaging Width PL4	800
---------------------	-----

Measurements

Z Measurement a	50
-----------------	----

Z Measurement a	50
-----------------	----

Z Measurement d	3/4
-----------------	-----

Z	35
---	----

Technical documents

[Download documents here](#) 

Uponor UK

Blackmor Lane The Pavillion
WD18 8GA, Watford
UK

T +44 (0)1923 381212
E
customerservice.uk.bfs@georgfi
scher.com