

## GF Malleable Fittings 132 - twin elbow, black 1 1/4

1153559

- Twin elbow, equal, ISO/EN E2

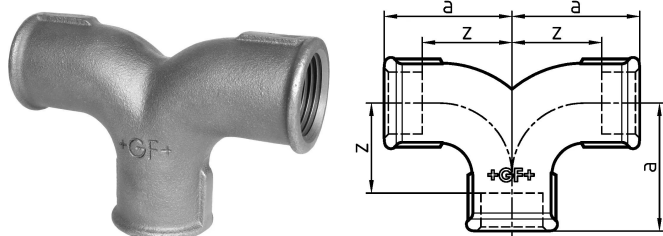

### About GF Malleable Fittings 132 - twin elbow, black

#### Specification

- Unique Whiteheart ductile Cast Iron to EN-GJMW-400-5 to BS EN 1562, design symbol A
- Thread type BSP - R or Rp to BS EN 10226-1 / ISO 7-1
- Union or flat-nut thread types to BS EN 228-1
- Manufactured to BS EN 10242 (ISO 49)
- Cast Iron is fire class A1 to BS EN 13501-1 (CWFT) acc. to Commission Decision 96/603/EC (as amended)
- Natural Black or Galvanized (99.995 zinc)
- Coated with medical-grade oil for corrosion protection
- Suitable for systems covered by the Pressure Equipment Safety Regulation:2016
- Max. pressure 25 bar up to 120 degrees, between 120-300 degrees use interpolated values, Max. 20bar at 300 degrees
- Sizes from 1/4" to 4"

#### Application

- Heating - LTHW, MTHW and HTHW
- Steam
- Chilled water and cooling applications
- Compressed air
- Fuel gases
- Fuel oils
- Fire defence / sprinklers

## GF Malleable Fittings 132 - twin elbow, black 1 1/4

1153559

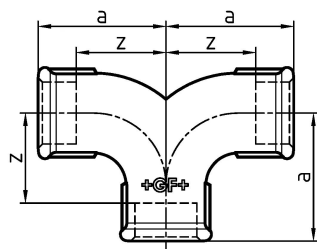

### Product code

Item no EAN	7611205317249
Item no GF	770132107
Item no GTIN	07611205317249
Item no RSK	1290063
Item no VVS	004132110

### Dimensions

Item Unit Height	55
Item Unit Length	152
Item Unit Weight	0,913
Item Unit Width	104
Item_UOM	pce

### Packaging

Packaging GTIN PL1	07611205117245
Packaging GTIN PL4	06414900181204
Packaging Height PL1	200
Packaging Height PL4	729
Packaging Length PL1	260
Packaging Length PL4	1200
Packaging Quantity PL1	8
Packaging Quantity PL4	432
Packaging Type PL1	Base_Box
Packaging Type PL4	Pallet
Packaging Volume PL1	0,00988
Packaging Volume PL4	0,69984
Packaging Weight PL1	7,518
Packaging Weight PL4	414,416
Packaging Width PL1	190

Packaging Width PL4	800
---------------------	-----

## Measurements

Z Measurement a	76
-----------------	----

Z Measurement a	76
-----------------	----

Z Measurement d	1 1/4
-----------------	-------

Z	57
---	----

## Technical documents

[Download documents here](#) 

### Uponor UK

Blackmor Lane The Pavillion  
WD18 8GA, Watford  
UK

T +44 (0)1923 381212

E

customerservice.uk.bfs@georgfi  
scher.com