

GF Malleable Fittings 270 - socket, galvanized 1/4 STA

1154018

- Socket, ISO/EN M2

- ST ... these types of fittings are made from steel (galvanised finish = electroplated) and not suitable for drinking water installations. Steel parts are hexagonal instead of beaded.

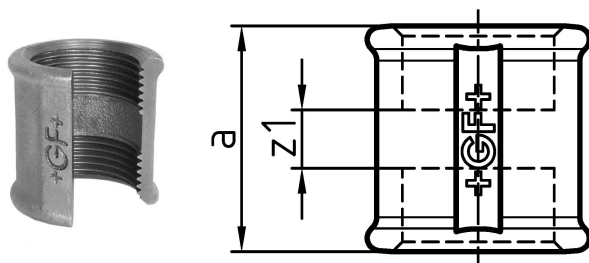

About GF Malleable Fittings socket

Specification

- Unique Whiteheart ductile Cast Iron to EN-GJMW-400-5 to BS EN 1562, design symbol A
- Thread type BSP - R or Rp to BS EN 10226-1 / ISO 7-1
- Union or flat-nut thread types to BS EN 228-1
- Manufactured to BS EN 10242 (ISO 49)
- Cast Iron is fire class A1 to BS EN 13501-1 (CWFT) acc. to Commission Decision 96/603/EC (as amended)
- Natural Black or Galvanized (99.995 zinc)
- Coated with medical-grade oil for corrosion protection
- Suitable for systems covered by the Pressure Equipment Safety Regulation:2016
- Max. pressure 25 bar up to 120 degrees, between 120-300 degrees use interpolated values, Max. 20bar at 300 degrees
- Sizes from 1/4" to 4"

Application

- Heating - LTHW, MTHW and HTHW
- Steam
- Chilled water and cooling applications
- Compressed air
- Fuel gases
- Fuel oils
- Fire defence / sprinklers

GF Malleable Fittings 270 - socket, galvanized 1/4 STA

1154018



Product code

| | |
|--------------|----------------|
| Item no EAN | 7611205428082 |
| Item no GF | 770270202 |
| Item no GTIN | 07611205428082 |
| Item no LVI | 0855161 |
| Item no NOBB | 60639126 |
| Item no NRF | 1366858 |
| Item no RSK | 1311166 |
| Item no VVS | 004270402 |

Dimensions

| | |
|------------------|--------|
| Item Unit Height | 23 |
| Item Unit Length | 23 |
| Item Unit Weight | 0,0305 |
| Item Unit Width | 27 |
| Item_UOM | pce |

Packaging

| | |
|------------------------|----------------|
| Packaging GTIN PL1 | 07611205628086 |
| Packaging GTIN PL2 | 07611205228088 |
| Packaging GTIN PL4 | 06414900124256 |
| Packaging Height PL1 | 23 |
| Packaging Height PL2 | 100 |
| Packaging Height PL4 | 508 |
| Packaging Length PL1 | 135 |
| Packaging Length PL2 | 260 |
| Packaging Length PL4 | 1200 |
| Packaging Quantity PL1 | 10 |
| Packaging Quantity PL2 | 100 |
| Packaging Quantity PL4 | 7200 |

| | |
|----------------------|-------------|
| Packaging Type PL1 | Plastic_Bag |
| Packaging Type PL2 | Medium_Box |
| Packaging Type PL4 | Pallet |
| Packaging Volume PL1 | 0,00164565 |
| Packaging Volume PL2 | 0,00494 |
| Packaging Volume PL4 | 0,48768 |
| Packaging Weight PL1 | 0,3096575 |
| Packaging Weight PL2 | 3,216575 |
| Packaging Weight PL4 | 256,5934 |
| Packaging Width PL1 | 530 |
| Packaging Width PL2 | 190 |
| Packaging Width PL4 | 800 |

Measurements

| | |
|------------------|-----|
| Wall thickness_s | 19 |
| Z Measurement a | 27 |
| Z Measurement a | 27 |
| Z Measurement d | 1/4 |
| Z MEASUREMENT S | 19 |
| z1 | 7 |

Technical documents

Download documents here

Uponor UK

Blackmor Lane The Pavillion
WD18 8GA, Watford
UK

T +44 (0)1923 381212

E
customerservice.uk.bfs@georgfi
scher.com