

## GF Malleable Fittings plug beaded 290 1/4 STA B

**1154101**

- Plug, beaded, ISO/EN T9
- 'ST' these types of fittings are made from steel (galvanised finish = electroplated)
- Not suitable for drinking water installations.
- \* Solid

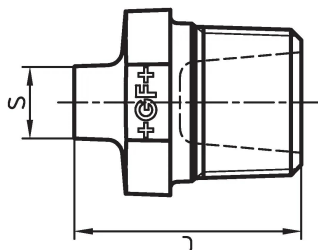

### About GF Malleable Fittings plug beaded 290

#### Specification

- Unique Whiteheart ductile Cast Iron to EN-GJMW-400-5 to BS EN 1562, design symbol A
- Thread type BSP - R or Rp to BS EN 10226-1 / ISO 7-1
- Union or flat-nut thread types to BS EN 228-1
- Manufactured to BS EN 10242 (ISO 49)
- Cast Iron is fire class A1 to BS EN 13501-1 (CWFT) acc. to Commission Decision 96/603/EC (as amended)
- Natural Black or Galvanized (99.995 zinc)
- Coated with medical-grade oil for corrosion protection
- Suitable for systems covered by the Pressure Equipment Safety Regulation:2016
- Max. pressure 25 bar up to 120 degrees, between 120-300 degrees use interpolated values, Max. 20bar at 300 degrees
- Sizes from 1/4" to 4"

#### Application

- Heating - LTHW, MTHW and HTHW
- Steam
- Chilled water and cooling applications
- Compressed air
- Fuel gases
- Fuel oils
- Fire defence / sprinklers

## GF Malleable Fittings plug beaded 290 1/4 STA B

1154101



### Product code

|              |                |
|--------------|----------------|
| Item no EAN  | 7611205329617  |
| Item no GF   | 770290102      |
| Item no GTIN | 07611205329617 |
| Item no LVI  | 0755167        |
| Item no RSK  | 1253999        |
| Item no VVS  | 004290102      |

### Dimensions

|                  |       |
|------------------|-------|
| Item Unit Height | 8     |
| Item Unit Length | 12    |
| Item Unit Weight | 0,022 |
| Item Unit Width  | 24    |
| Item_UOM         | pce   |

### Packaging

|                        |                |
|------------------------|----------------|
| Packaging GTIN PL1     | 07611205529611 |
| Packaging GTIN PL2     | 07611205129613 |
| Packaging GTIN PL4     | 06414900121187 |
| Packaging Height PL1   | 8              |
| Packaging Height PL2   | 100            |
| Packaging Height PL4   | 508            |
| Packaging Length PL1   | 135            |
| Packaging Length PL2   | 260            |
| Packaging Length PL4   | 1200           |
| Packaging Quantity PL1 | 10             |
| Packaging Quantity PL2 | 100            |
| Packaging Quantity PL4 | 7200           |
| Packaging Type PL1     | Plastic_Bag    |
| Packaging Type PL2     | Medium_Box     |

|                      |           |
|----------------------|-----------|
| Packaging Type PL4   | Pallet    |
| Packaging Volume PL1 | 0,0005724 |
| Packaging Volume PL2 | 0,00494   |
| Packaging Volume PL4 | 0,48768   |
| Packaging Weight PL1 | 0,2246575 |
| Packaging Weight PL2 | 2,366575  |
| Packaging Weight PL4 | 195,3934  |
| Packaging Width PL1  | 530       |
| Packaging Width PL2  | 190       |
| Packaging Width PL4  | 800       |

## Technical documents

Download documents here 

### Uponor UK

Blackmor Lane The Pavilion  
WD18 8GA, Watford  
UK

T +44 (0)1923 927000  
E [enquiries.uk@uponor.com](mailto:enquiries.uk@uponor.com)

[www.uponor.com/en-gb](http://www.uponor.com/en-gb)