

GF Malleable Fittings plug beaded 290 1 1/2 B

1154107

Plug, beaded, ISO/EN T9

- ST ... these types of fittings are made from steel (galvanised finish = electroplated) and not suitable for drinking water installations.
- * Solid

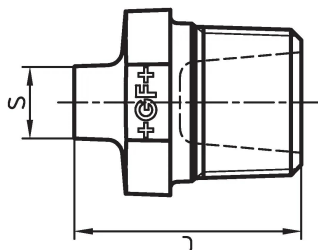

About GF Malleable Fittings plug beaded 290

Specification

- With their extensive history and tradition, malleable cast iron fittings are the most common pipe fittings. Because of their durability and mechanical strength, these fittings are very popular. The material is able to endure high mechanical stress and when combined with the standardized jointing method can be used in a wide range of applications.

Application

- Sanitary, heating and gas installation, mechanical engineering (oil, cool pipework), construction of petrol stations (gas lines), sprinkler

GF Malleable Fittings plug beaded 290 1 1/2 B

1154107

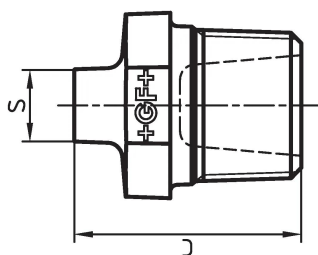

Product code

Item no EAN	7611205329747
Item no GF	770290108
Item no GTIN	07611205329747
Item no LVI	0755173
Item no NOBB	60639180
Item no NRF	1366912
Item no RSK	1254011
Item no VVS	004290111

Dimensions

Item Unit Height	55
Item Unit Length	60
Item Unit Weight	0,322
Item Unit Width	47
Item_UOM	pce

Packaging

Packaging GTIN PL1	07611205129743
Packaging GTIN PL4	06414900121125
Packaging Height PL1	200
Packaging Height PL4	534
Packaging Length PL1	260
Packaging Length PL4	1200
Packaging Quantity PL1	50
Packaging Quantity PL4	1800
Packaging Type PL1	Base_Box
Packaging Type PL4	Pallet
Packaging Volume PL1	0,00988
Packaging Volume PL4	0,51264

Packaging Weight PL1	16,314
Packaging Weight PL4	599,6
Packaging Width PL1	190
Packaging Width PL4	800

Technical documents

Download documents here 

Uponor UK

Blackmor Lane The Pavilion
WD18 8GA, Watford
UK

T +44 (0)1923 927000
E enquiries.uk@uponor.com

www.uponor.com/en-gb