

GF Malleable Fittings union CuSn/Fe seat 342 1 B

1154444

Union, spherical seat/taper seat Bronze to Iron, ISO/EN U11

- Torque and notes for installation please find in "Technical Product Notes".
- Not suitable for drinking water installation!

374 G ... refers to the thread size G according to ISO 228 of the union nut 374.

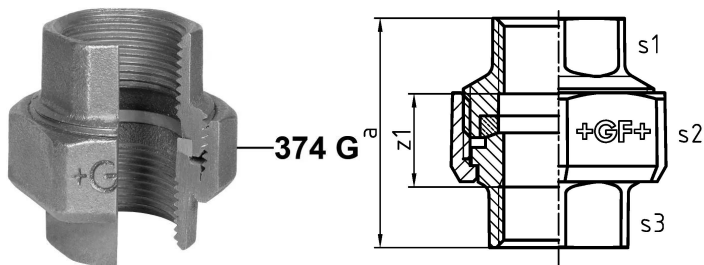

About GF Malleable Fittings union CuSn/Fe seat 342

Specification

- With their extensive history and tradition, malleable cast iron fittings are the most common pipe fittings. Because of their durability and mechanical strength, these fittings are very popular. The material is able to endure high mechanical stress and when combined with the standardized jointing method can be used in a wide range of applications.

Application

- Sanitary, heating and gas installation, mechanical engineering (oil, cool pipework), construction of petrol stations (gas lines), sprinkler

GF Malleable Fittings union CuSn/Fe seat 342 1 B

1154444

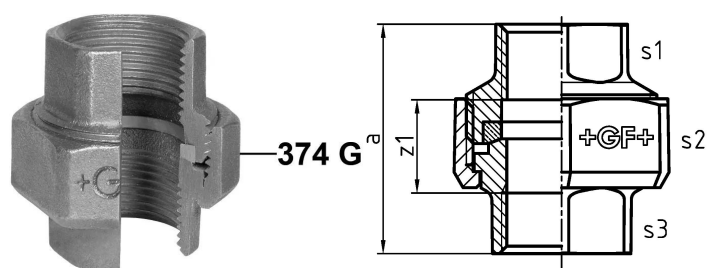

Product code

Item no EAN	7611205338886
Item no GF	770342106
Item no GTIN	07611205338886
Item no RSK	1260883

Dimensions

Item Unit Height	55
Item Unit Length	59
Item Unit Weight	0,3726
Item Unit Width	58
Item_UOM	pce

Packaging

Packaging GTIN PL1	07611205138882
Packaging GTIN PL4	06414900119597
Packaging Height PL1	200
Packaging Height PL4	729
Packaging Length PL1	260
Packaging Length PL4	1200
Packaging Quantity PL1	30
Packaging Quantity PL4	1620
Packaging Type PL1	Base_Box
Packaging Type PL4	Pallet
Packaging Volume PL1	0,00988
Packaging Volume PL4	0,69984
Packaging Weight PL1	11,392
Packaging Weight PL4	623,612
Packaging Width PL1	190
Packaging Width PL4	800

Technical documents

Download documents here 

Uponor UK

Blackmor Lane The Pavilion
WD18 8GA, Watford
UK

T +44 (0)1923 927000
E enquiries.uk@uponor.com

www.uponor.com/en-gb