

## GF Malleable Fittings distribution union bush flat seat 378 1 G

1154637

Distributed union bush, flat seat

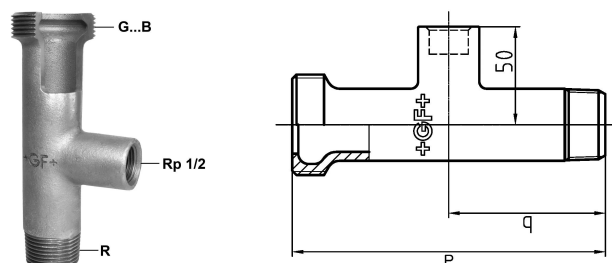

### About GF Malleable Fittings distribution union bush flat seat 378

#### Specification

- With their extensive history and tradition, malleable cast iron fittings are the most common pipe fittings. Because of their durability and mechanical strength, these fittings are very popular. The material is able to endure high mechanical stress and when combined with the standardized jointing method can be used in a wide range of applications.

#### Application

- Sanitary, heating and gas installation, mechanical engineering (oil, cool pipework), construction of petrol stations (gas lines), sprinkler

## GF Malleable Fittings distribution union bush flat seat 378 1 G 1154637

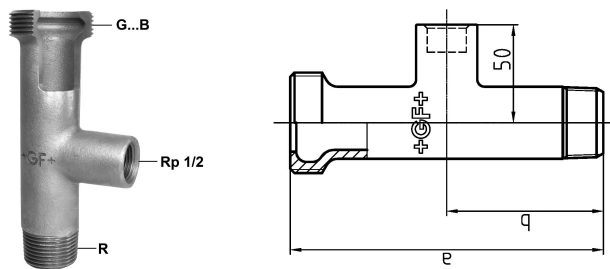

### Technical documents

Download documents here 

#### Uponor UK

Blackmor Lane The Pavilion  
WD18 8GA, Watford  
UK

T +44 (0)1923 927000  
E [enquiries.uk@uponor.com](mailto:enquiries.uk@uponor.com)

[www.uponor.com/en-gb](http://www.uponor.com/en-gb)