

## GF Malleable Fittings extension tube 526 3/4 40 G

**1154745**

- Extension tube
- \* Due to overall fitting length, the length of the external thread does not comply with the standard.

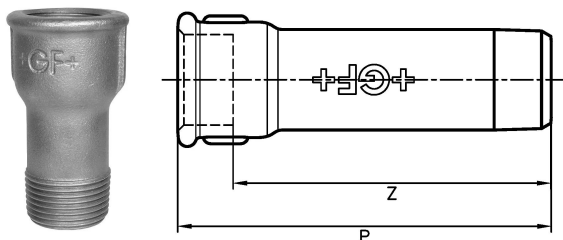

### About GF Malleable Fittings extension tube 526

#### Specification

- Unique Whiteheart ductile Cast Iron to EN-GJMW-400-5 to BS EN 1562, design symbol A
- Thread type BSP - R or Rp to BS EN 10226-1 / ISO 7-1
- Union or flat-nut thread types to BS EN 228-1
- Manufactured to BS EN 10242 (ISO 49)
- Cast Iron is fire class A1 to BS EN 13501-1 (CWFT) acc. to Commission Decision 96/603/EC (as amended)
- Natural Black or Galvanized (99.995 zinc)
- Coated with medical-grade oil for corrosion protection
- Suitable for systems covered by the Pressure Equipment Safety Regulation:2016
- Max. pressure 25 bar up to 120 degrees, between 120-300 degrees use interpolated values, Max. 20bar at 300 degrees
- Sizes from 1/4" to 4"

#### Application

- Heating - LTHW, MTHW and HTHW
- Steam
- Chilled water and cooling applications
- Compressed air
- Fuel gases
- Fuel oils
- Fire defence / sprinklers

## GF Malleable Fittings extension tube 526 3/4 40 G

1154745



### Status

Item Available From date

2025-09-05

### Product code

Item no EAN	7611205452827
Item no GF	770526228
Item no GTIN	07611205452827
Item no RSK	1363762
Item no VVS	004526446

### Dimensions

Item Unit Height	38
Item Unit Length	38
Item Unit Weight	0,1
Item Unit Width	40
Item_UOM	pce

### Measurements

LENGTH_L	40
Z	25

### Packaging

Packaging GTIN PL1	07611205652821
Packaging GTIN PL2	07611205252823
Packaging GTIN PL4	06414900239318
Packaging Height PL1	38
Packaging Height PL2	100
Packaging Height PL4	508
Packaging Length PL1	180
Packaging Length PL2	260
Packaging Length PL4	1200
Packaging Quantity PL1	10

Packaging Quantity PL2	50
Packaging Quantity PL4	3600
Packaging Type PL1	Plastic_Bag
Packaging Type PL2	Medium_Box
Packaging Type PL4	Pallet
Packaging Volume PL1	0,0036252
Packaging Volume PL2	0,00494
Packaging Volume PL4	0,48768
Packaging Weight PL1	1,01
Packaging Weight PL2	5,15
Packaging Weight PL4	395,8
Packaging Width PL1	530
Packaging Width PL2	190
Packaging Width PL4	800

## Technical documents

[Download documents here](#)

### Uponor UK

Blackmor Lane The Pavilion  
WD18 8GA, Watford  
UK

T +44 (0)1923 927000  
E [enquiries.uk@uponor.com](mailto:enquiries.uk@uponor.com)

[www.uponor.com/en-gb](http://www.uponor.com/en-gb)