

GF Malleable Fittings longscREW 535 3/4 G

1154773

Longscrew hexagon nipple, complete

- * Large chamfer (gasket chamber)

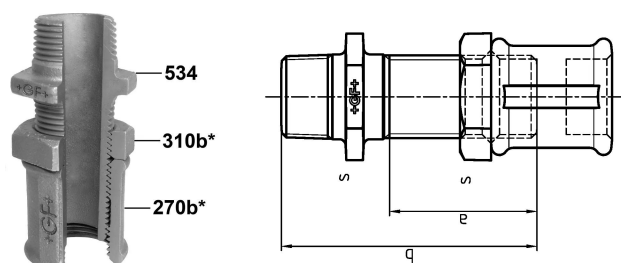

About GF Malleable Fittings longscREW 535

Specification

- With their extensive history and tradition, malleable cast iron fittings are the most common pipe fittings. Because of their durability and mechanical strength, these fittings are very popular. The material is able to endure high mechanical stress and when combined with the standardized jointing method can be used in a wide range of applications.

Application

- Sanitary, heating and gas installation, mechanical engineering (oil, cool pipework), construction of petrol stations (gas lines), sprinkler

GF Malleable Fittings longscrew 535 3/4 G

1154773

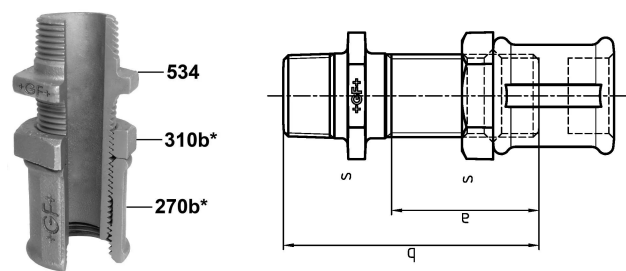

Status

Item Available From date

2025-09-05

Product code

Item no EAN	7611205456306
Item no GF	770535205
Item no GTIN	07611205456306
Item no RSK	1316357
Item no VVS	004535406

Dimensions

Item Unit Height	38
Item Unit Length	42
Item Unit Weight	0,328
Item Unit Width	82
Item_UOM	pce

Packaging

Packaging GTIN PL1	07611205256302
Packaging GTIN PL4	06414900239080
Packaging Height PL1	200
Packaging Height PL4	534
Packaging Length PL1	260
Packaging Length PL4	1200
Packaging Quantity PL1	50
Packaging Quantity PL4	1800
Packaging Type PL1	Base_Box
Packaging Type PL4	Pallet
Packaging Volume PL1	0,00988
Packaging Volume PL4	0,51264
Packaging Weight PL1	16,614

Packaging Weight PL4	610,4
Packaging Width PL1	190
Packaging Width PL4	800
Measurements	
Wall thickness_s	36

Technical documents

Download documents here 

Uponor UK

Blackmor Lane The Pavilion
WD18 8GA, Watford
UK

T +44 (0)1923 927000
E enquiries.uk@uponor.com

www.uponor.com/en-gb